

壁挂式节水型小便器  
Wall Mounted Urinal (Compact)

UWN926系列/  
UWN926 Series

安全注意事项/安装前的注意事项 Cautions and Warnings/Before Installing	· · · P.2 · · · P.3
完成图 / As-fitted Drawing	· · · P.4
同捆零件 / Included Parts	· · · P.5
需准备的工具 / Required Tools	· · · P.5
关于各部位 / About Parts	· · · P.6
安装方法 / Installation Method	· · · P.7

为了充分发挥产品的性能，请按施工说明书内容正确安装。  
安装后，请向顾客详细说明使用方法。 /  
Perform the installation work properly according to this Installation Guide so that the product can function well.  
After installation, fully explain how to use it to your customer.





## 安全注意事项（为了您的安全，请务必遵守）



安装前，请仔细阅读「安全注意事项」。并根据其内容正确安装。  
为了使您能正确地安装该产品，防止危害您或他人的安全及财产损坏，本说明书记载了各种标志。  
标志的意思说明如下。

 <b>警告</b>	表示如果忽视该标志栏的内容，错误操作，将可能导致人员死亡或重伤。	 <b>注意</b>	表示如果无视此标志而误操作时，有可能造成人身伤害或财产损失。
--	----------------------------------	--	--------------------------------

应遵守的内容种类用以下标志区分进行说明。

	 表示不得进行的“禁止”内容。 左图表示“禁止在浴池、淋浴器使用”。		 表示必须实行的“强制”内容。 左图表示“必须实行”。
---	--	---	---

 <b>警告</b>	
 潮湿环境禁止使用	<ul style="list-style-type: none"> <li>● <b>不要安装在浴室内等潮湿场所</b> 否则会造成故障、漏电。</li> </ul>
 禁止拆解	<ul style="list-style-type: none"> <li>● <b>除维修技术人员之外，其他人绝不要拆解、维修、改装</b> 否则有可能会引起故障、触电、受伤。</li> </ul>

 <b>注意</b>	
 必须实行	<ul style="list-style-type: none"> <li>● <b>必须要有2人以上进行施工</b> 否则有可能会使腰受伤，或是陶瓷掉落造成损坏。</li> <li>● <b>施工后，必须要进行试运行，确认各部分没有漏水</b> 如安装不到位，就有可能漏水，造成财产损失，如淋湿家具等。</li> </ul>

## 安装前的注意事项

- 给水和电器施工前，请对施工工序进行充分的商讨。
- 由于包装前会进行通水检查，因此商品内有可能留有水分，但对商品无影响。





## Cautions and warnings (For safety, be sure to follow these)

Before installation, read these "Cautions and Warnings" carefully and attach the equipment correctly.



This manual uses various symbol examples to provide guidance on safely installing the product and to prevent injury to customers or other people and damage to property.



The symbol examples and their meanings are as follows.

 <b>WARNING</b>	This indicates that misoperation could result in death or serious injury.	 <b>CAUTION</b>	This indicates that misoperation could result in injury or property damage.
---	---	---	---

The types of information that must be followed are classified and explained with the following pictograms.

	 indicates a prohibited use of the product. The symbol to the left indicates that "use is prohibited in bathrooms and shower stalls."		 indicates a required step in the use of this product. The symbol to the left indicates the action is "Required."
---	---	---	---

 <b>WARNING</b>			
 Use prohibited near water	<ul style="list-style-type: none"> <li>● <b>Do not install in locations of high humidity such as bathrooms</b> Doing so may cause a malfunction or current leak.</li> </ul>		
 Do not disassemble	<ul style="list-style-type: none"> <li>● <b>People other than repair technicians should never disassemble, repair, or alter the product</b> Doing so may cause a malfunction, electrical shock, or injury.</li> </ul>		

 <b>CAUTION</b>			
 Required	<ul style="list-style-type: none"> <li>● <b>Always carry out construction work with at least two people</b> Otherwise, the installer may injure his or her lower back, or drop the porcelain and damage it.</li> <li>● <b>After construction, be sure to give the product a test run and check that there are no water leaks in any part</b> Not installing the product properly may cause water leaks that could result in flooding damage to property, such as household belongings.</li> </ul>		

## Before Installing

- **Thoroughly discuss the relevant procedures before performing water work.**
- **A water supply inspection has been conducted prior to packaging. There may be some water remaining inside the product, but this is normal.**



Technical drawing of a toilet showing front and side views with dimensions in millimeters.

**Front View Dimensions:**

- Overall height: 400
- Overall width: 306

**Side View Dimensions:**

- Overall height: 936
- Height to top of bowl: 590
- Height to center of discharge pipe: 600
- Height to bottom of bowl: 346
- Height to finished floor surface: 465
- Height of discharge pipe outlet: 113
- Height of bowl rim: 39
- Height of bowl to center of discharge pipe: 150
- Width of bowl: 87
- Width of discharge pipe outlet: 32
- Width of bowl to center of discharge pipe: 150

**Labels:**

- 排水管的中心线 / Center line of discharge pipe
- 完成地面 / Finished floor surface



## 同捆零件/Included Parts

※零件是否齐全，请参照以下进行确认。/

\* Refer to the following and confirm that no parts are missing.

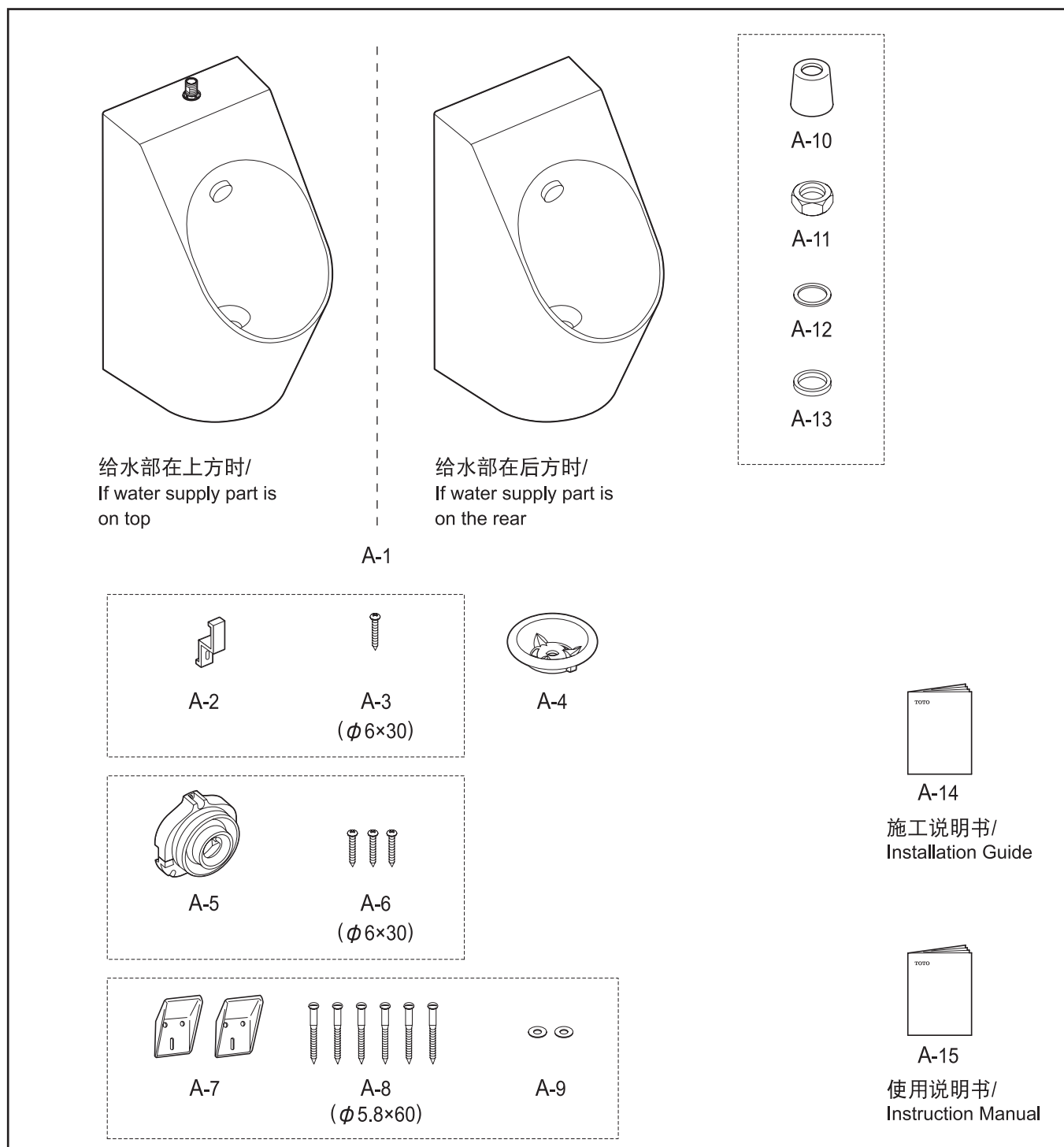

## 需准备的工具/Required Tools

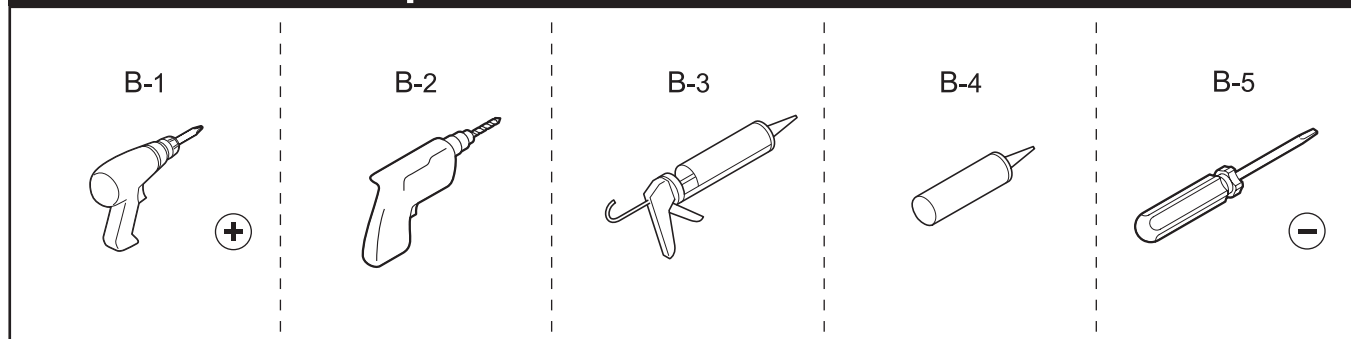



## 关于各部位/About Parts

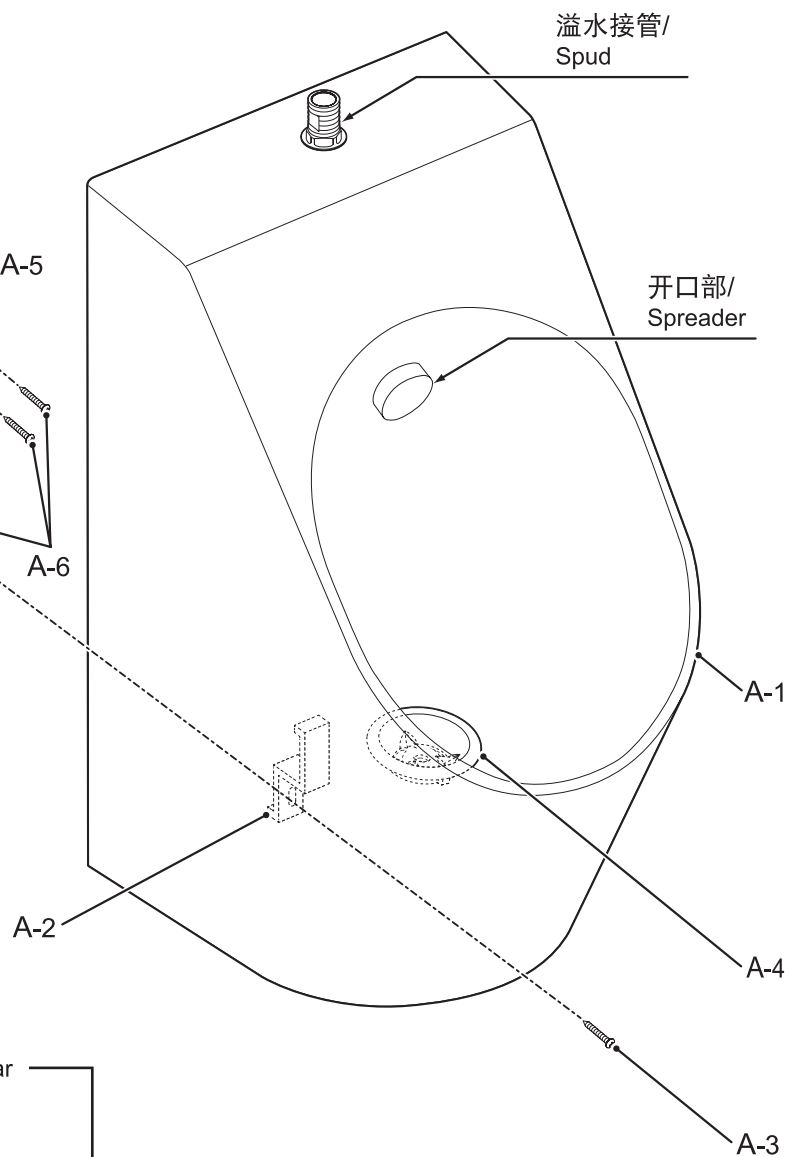
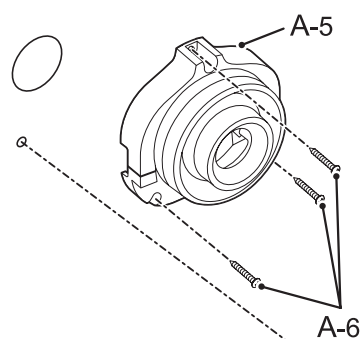
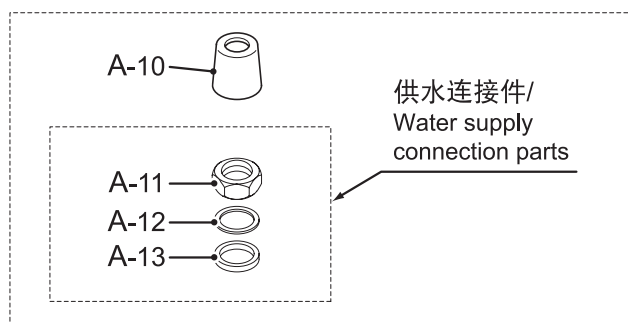
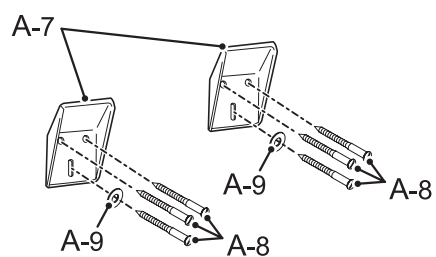

给水部在后方时/  
If water supply part is on the rear

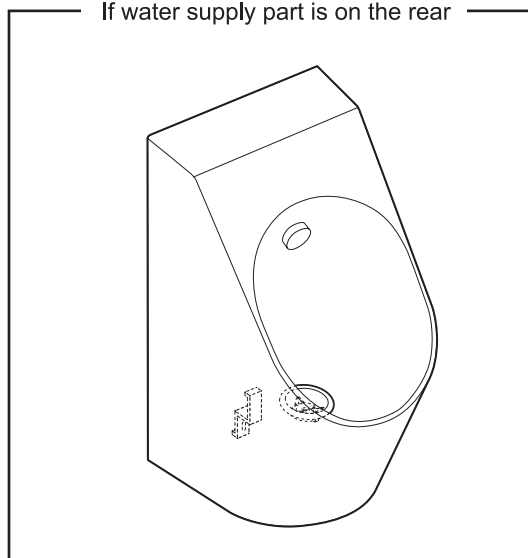



# 安装方法/Installation Method

## ZH 标志的意思

↓ : 安装者必须实施的操作。

👁 : 必须确认的作业。

⇓ : 操作流程。

## EN Meaning of the symbol examples

↓ : Task that must be conducted by the installer.

👁 : Work that requires confirmation.

⇓ : Shows the work sequence.

1

排水套管的安装方法/  
Discharge socket installation method

1

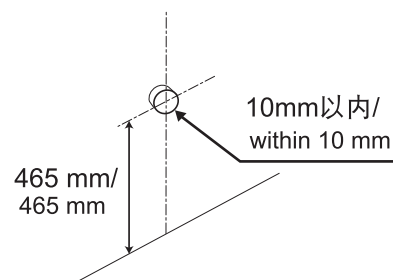

2

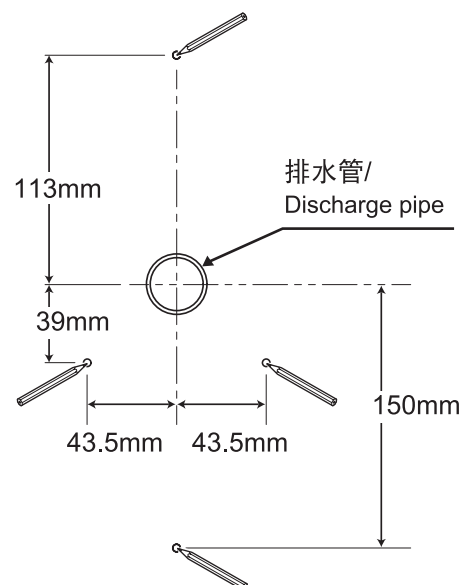

3

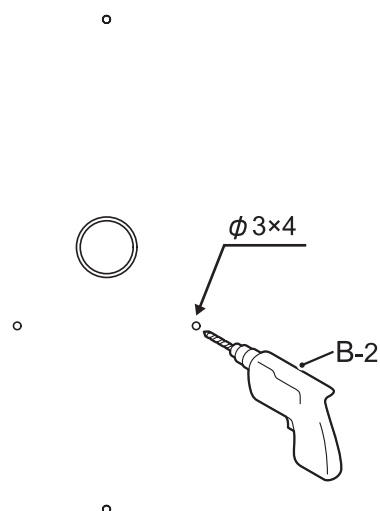



4

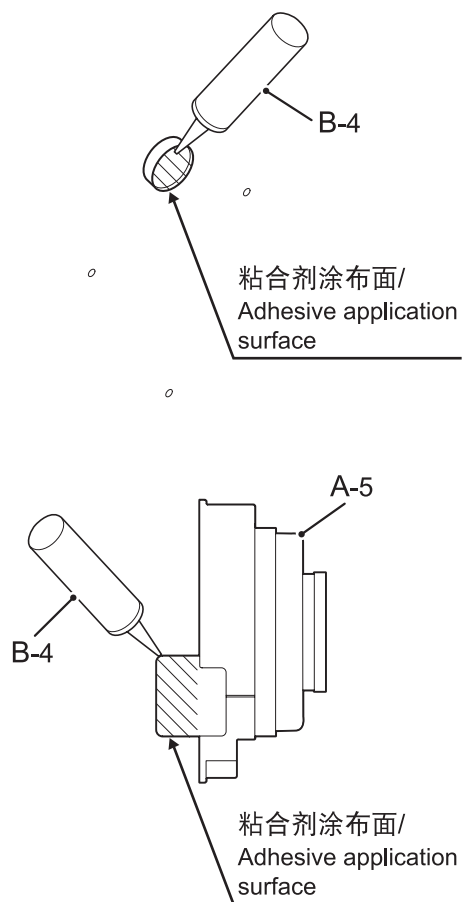

5

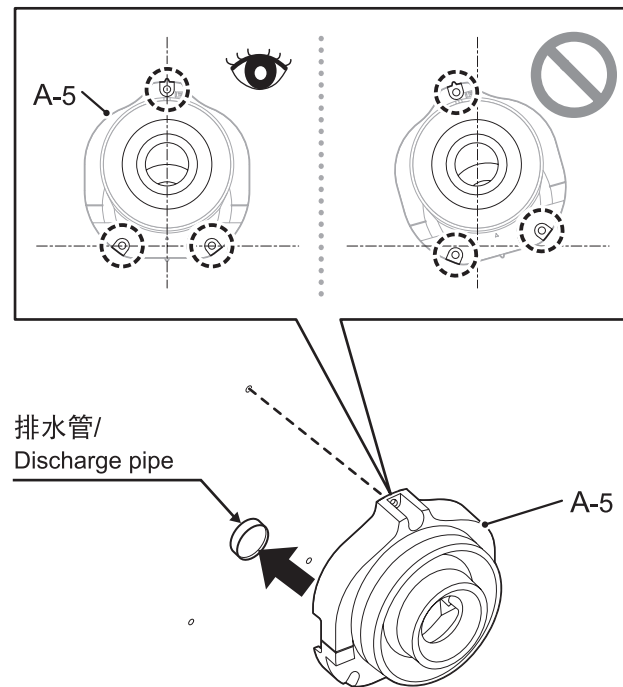

※一次粘合将无法返工，所以请多加注意。/

\* Be careful, as it cannot be adjusted after it is attached.

ZH

⚠ 注意



必须实行

- 排水套管（A-5）本体与聚氯乙烯排水管的衔接如有松动，使用普通型的粘合剂有可能会引起漏水，所以务必要使用高粘度型的粘合剂。使用普通型的粘合剂有可能会漏水，造成财产损失，如淋湿家具等。

EN

⚠ CAUTION



Required

- If the fit between the discharge socket (A-5) unit and PVC discharge pipe is loose, be sure to use high viscosity type adhesive, as general-use adhesive could cause water leaks to occur. General-use adhesive could cause water leaks that could result in flooding damage to property, such as household belongings.



6

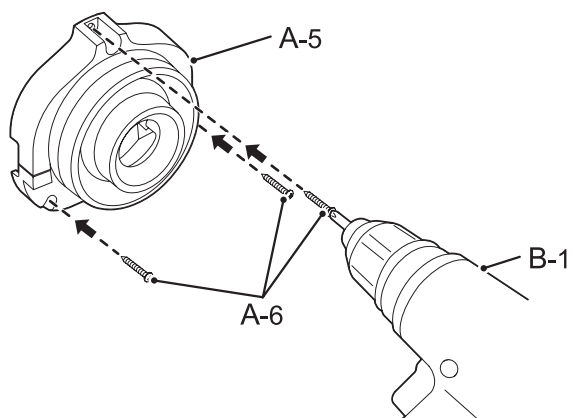

2

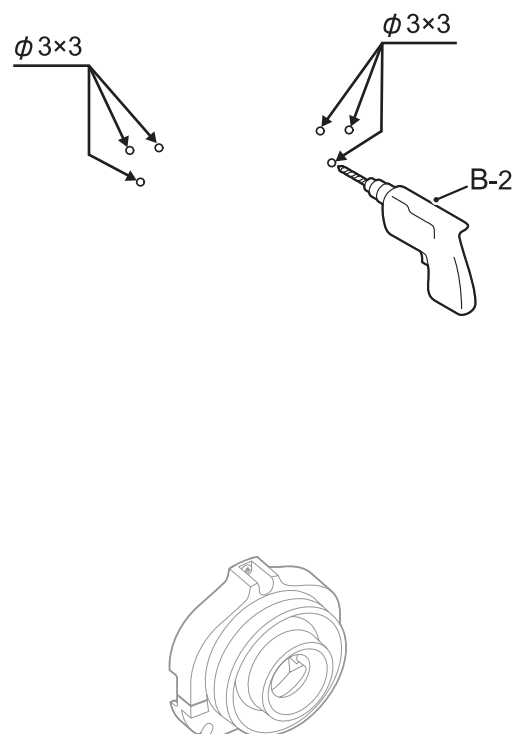

2

后背吊钩的安装方法/  
Back hanger installation method

1

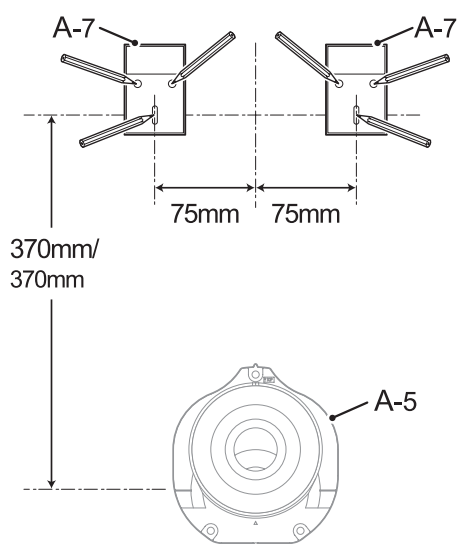

3

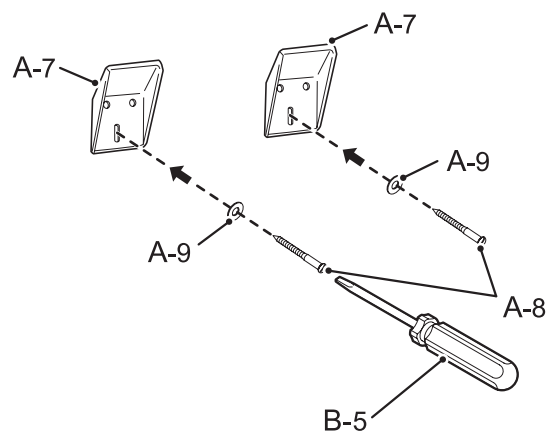

9



4

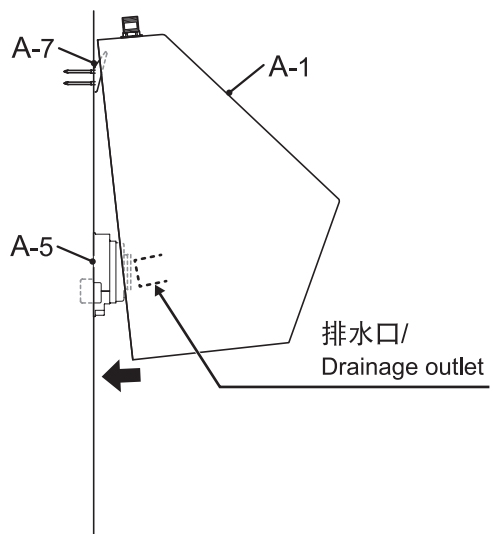

5

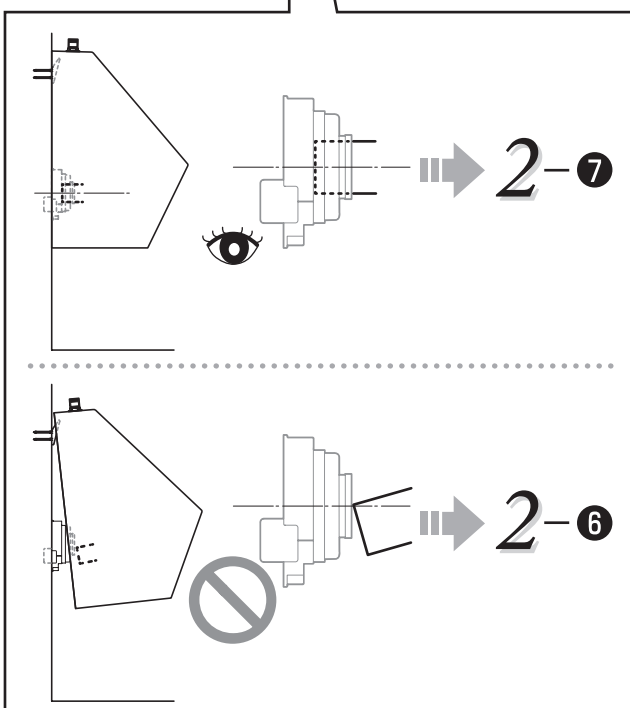
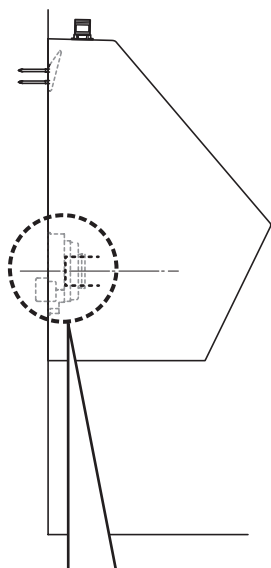

6

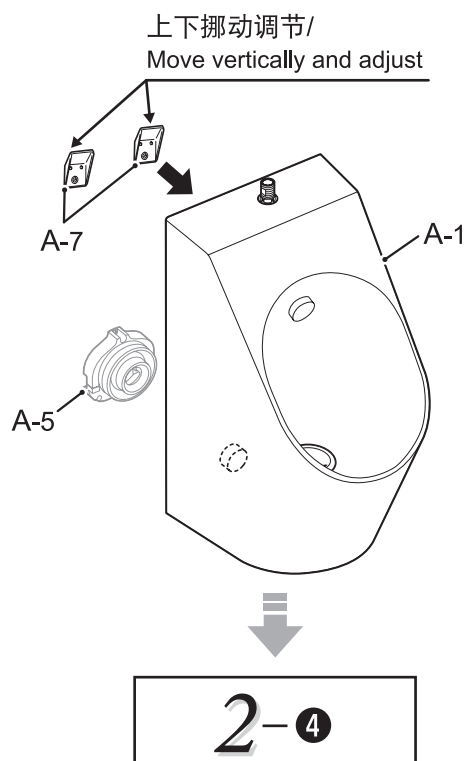

7

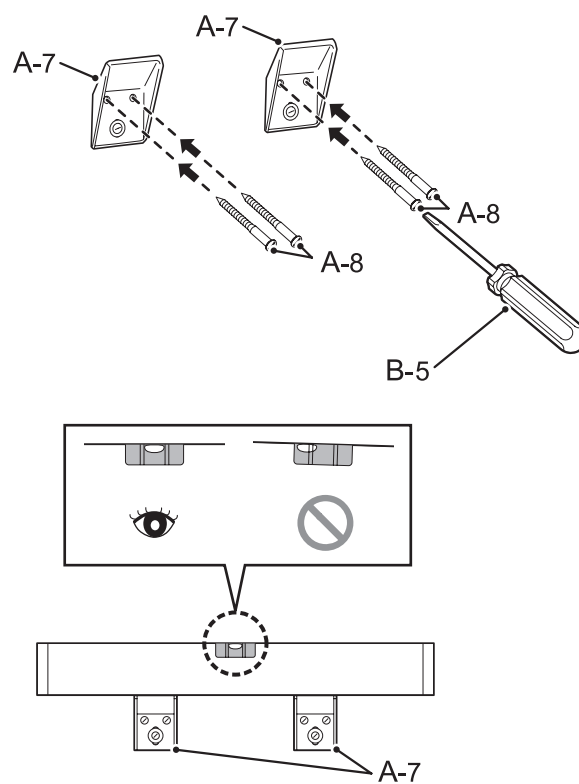



此时，如果小便器（A-1）没有达到规定高度，可拧松后背吊钩（A-7）的木螺钉（A-8），在与墙壁之间塞入金属片进行调整。/

If the urinal (A-1) does not reach the indicated height, loosen the back hanger's (A-7) wood screws (A-8), then place a metal plate between it and the wall to adjust it.

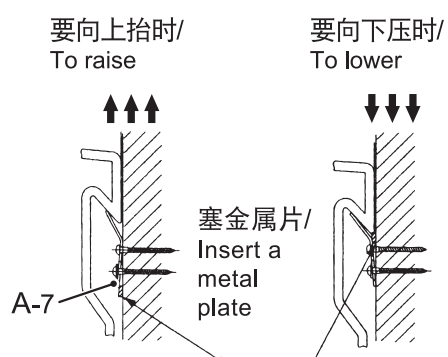

3

①

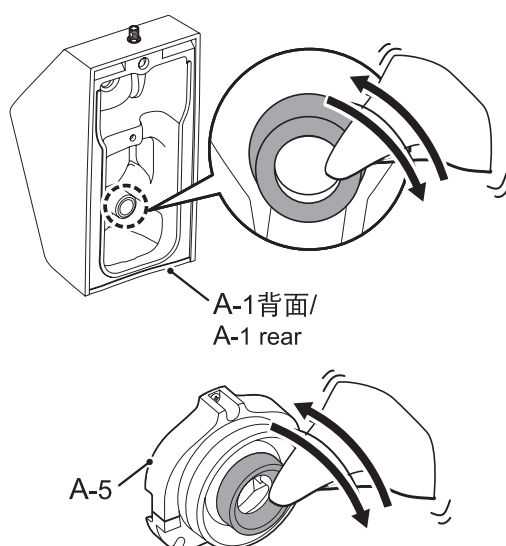

2

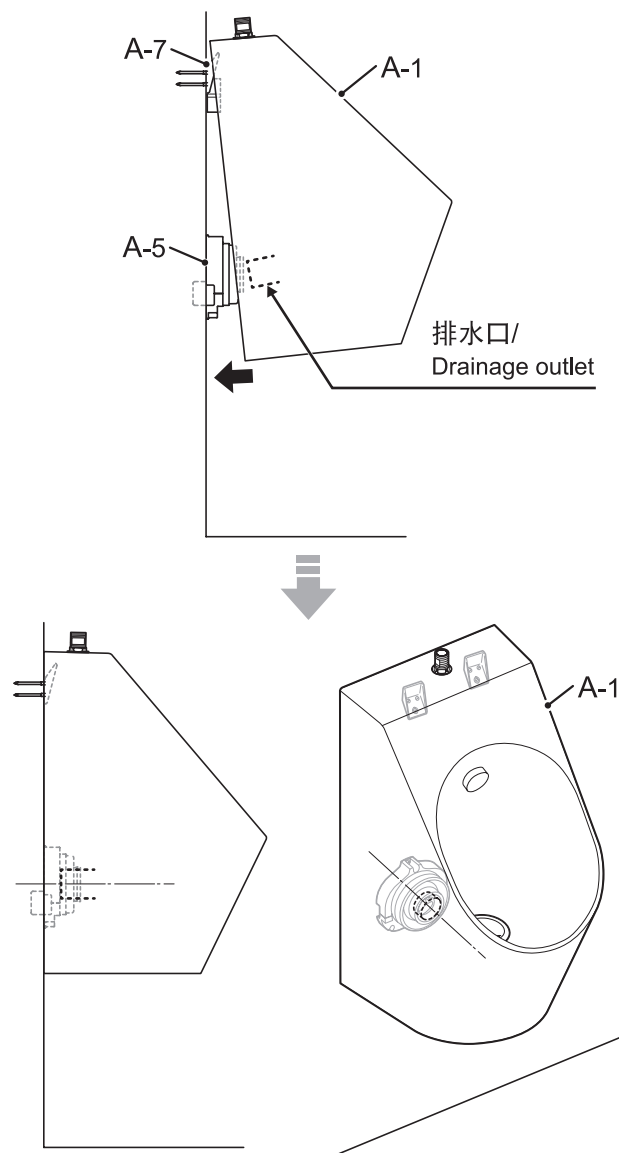

ZH

⚠ 注意



禁止

- 安装小便器（A-1）时，不要从排水口侧安装  
否则A-5（排水套管）处会漏水，造成财产损失，如淋湿家具等。

EN

⚠ CAUTION



Prohibited

- Do not install the urinal (A-1) from the drainage outlet side  
Doing so could cause water leaks from A-5 (the discharge socket) that could result in flooding damage to property, such as household belongings.



3

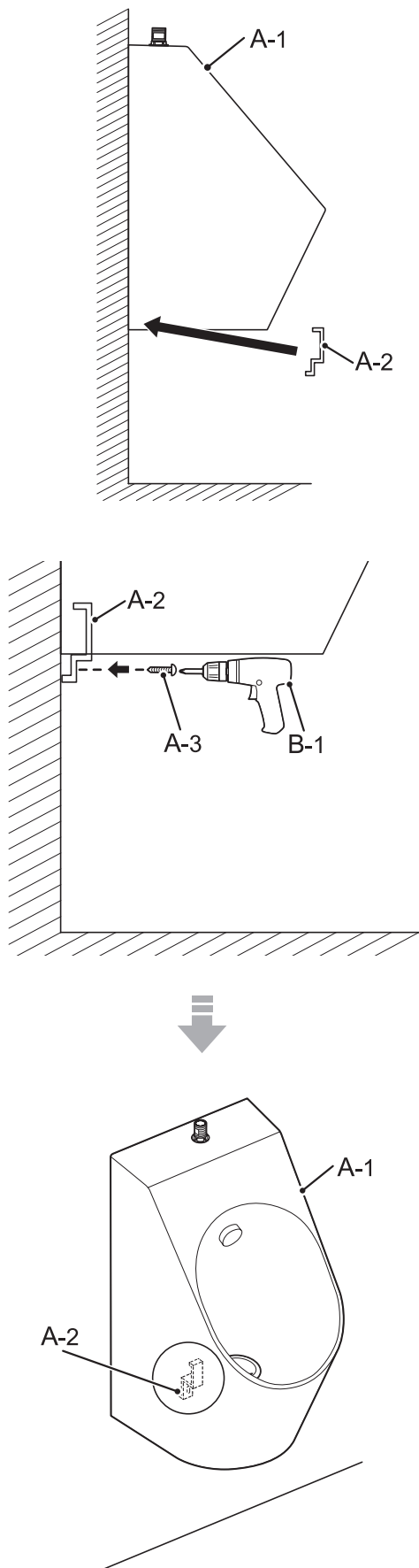

4

关于给水金属件的安装方法，请另行参照给水金属件的施工说明书来进行安装。/

Install the water supply fixture. Refer to the separate Water Supply Fixture Installation Guide for details on how to install it.

ZH

⚠ 注意



禁止

- 不要松开或者拆下固定溢水接管的螺母  
如果改变开口部的位置和方向，有可能会引起水的飞溅和冲洗不良。



必须实行

- 带帽螺母（下方）是通过工具等来紧固溢水接管  
如果溢水接管共转，有可能会引起水的飞溅和冲洗不良。

EN

⚠ CAUTION



Prohibited

- **Do not loosen or remove the nut fixing the spud in place**  
Doing so could change the position or orientation of the spreader, causing water to spray or inadequate flushing.



Required

- **When tightening the cap nut (lower), use a tool or the like to fix the spud in place**  
Otherwise, the spud could turn along with the cap nut, causing water to spray or inadequate flushing.



5

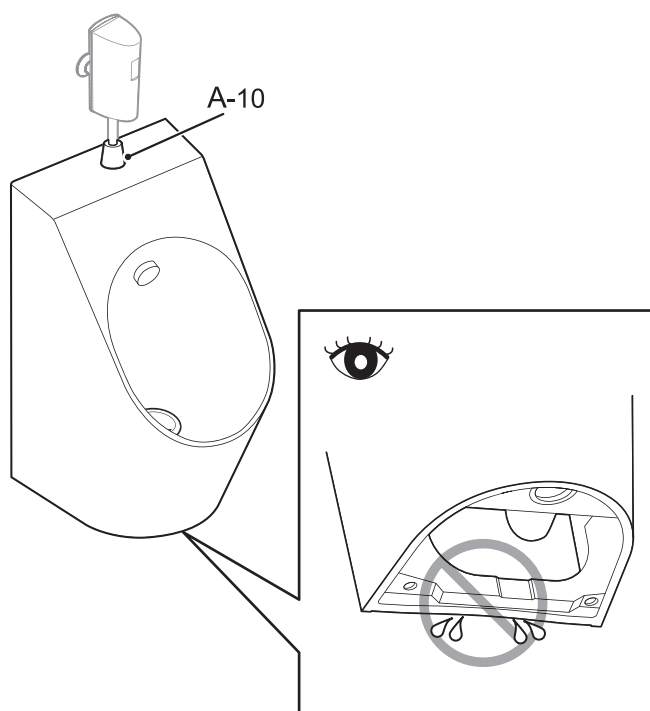

7

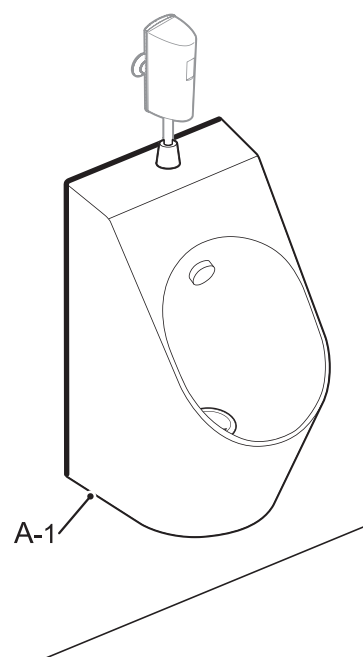

※如果水流过大，可能会导致冲洗飞沫和水花飞溅增加。  
如果水流过大，则需另行参照给水金属件的使用说明书进行调节。/

\* If the water pressure is too strong, water could often splash during flushing or spray.  
If the water pressure is too strong, refer to the separate Water Supply Fixture Instruction Manual and adjust the pressure.

6

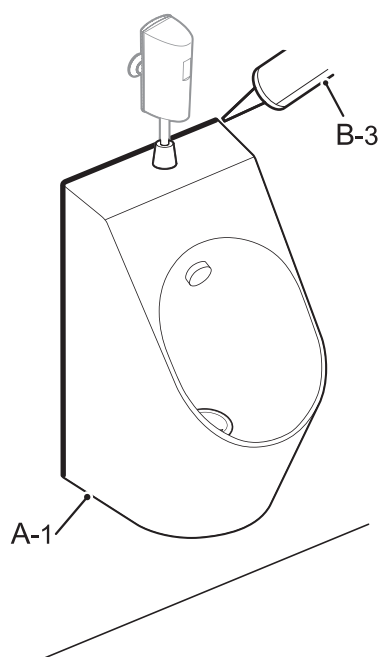



# 备忘录/MEMO





# 备忘录/MEMO



