

TOTO

施工说明书 Instructions for construction

安装产品前请仔细阅读本施工说明书，并保留备用。
Before product installation, read these instructions for construction carefully and retain it for future reference.

TOTO

OG3491Y(B)
2021.09

目录

目 录	
目 录.....	1
明细单.....	2-3
使用条件与施工上的注意.....	4
施工上的注意和保养.....	5
安装完成图.....	6-11
水嘴的安装.....	12-15
生产厂家与销售商.....	16

明细单

明细单	
本 体 部.....	1套
施工说明书.....	1本
使用说明书.....	1本
使用此明细单的产品包括：	
DV104	铜合金壁式单柄暗装双向转换阀体（开闭切换）
DV105R	铜合金壁式单柄暗装单向转换阀体（开闭切换）
DV105-1	铜合金壁式单柄暗装单向转换阀体（开闭切换）
DV357	铜合金壁式单柄暗装双向转换阀体
DV104-1R	铜合金壁式单柄暗装双向转换阀体（开闭切换）
DP355 系列水嘴面板部与DV104系列水嘴本体部配套使用；	
DP354 系列水嘴面板部与DV105R系列水嘴本体部配套使用；	
DP357 系列水嘴面板部与DV357系列水嘴本体部配套使用。	

明细单

明细单

面板部.....	1套
施工说明书.....	1本
使用说明书.....	1本

使用此明细单的产品包括：

DP354 铜合金壁式单柄暗装单向转换面板

DP355 铜合金壁式单柄暗装双向转换面板（开闭切换）

DP357 铜合金壁式单柄暗装双向转换面板

使用条件与施工上的注意

使用条件

- 1. 供冷水*热水压力：
最低压力.....0.05MPa（流动压）
最高压力.....1.0MPa（静压）
- 2. 供水温度在4℃～90℃，建议使用热水温度60±5℃，供热水请勿使用蒸汽。
- 3. 使用环境温度0℃以上。如果低于0℃，水嘴会出现变形、冻裂等现象。
- 4. 为防止花洒内部损坏，花洒侧吐水温度不得超过60℃，建议使用温度45℃以下。
- 5. 长时间不使用时，可能导致水嘴内部及外部锈蚀不能使用等现象。
- 6. 如果您需要废弃本产品，请勿将其作为一般生活垃圾处理，请依照法规经由独立的回收体系进行合适的处理、恢复和回收。
- 7. 本说明书中的产品具有清洗功能。

施工上的注意

 **警告** 表示如果无视此标志而误操作时，有可能造成人员重伤或死亡。

 **注意** 表示如果无视此标志而误操作时，有可能造成人身伤害或财产损失。

警告

- 1. 水嘴的供热水一侧处于高温状态，请勿使皮肤直接接触五金配件表面，否则可能会烫伤。
- 2. 请勿配反冷*热水配管，否则可能会烫伤。
- 3. 供热水请勿使用蒸汽，否则可能会烫伤。
- 4. 如果客户不使用我司水嘴自带的进水口过滤网，可能会出现阀芯因异物进入而导致的漏水或破损的风险。
- 5. 施工时本产品的G1/2或G3/4内螺纹请勿与R1/2或R3/4接头安装使用，否则可能会造成主体螺纹处开裂、漏水等不良。

施工上的注意和保养

⚠ 注意

- 1. 由于陶瓷阀芯是较精密的部件，请勿擅自分解，否则可能会造成漏水等不良。
- 2. 请勿撞击本产品，否则可能会造成故障、漏水。
- 3. 随着产品式样的不断更新，实物存在与图示不符的情况，但基本安装、使用原理相同。
- 4. 在可能结冰的场所使用时，要切实做好防冻措施。
因结冰，零件破损，有可能导致漏水，造成财产损失。因结冰而造成的破损即使在保修期内也是有偿修理。请不要让产品的环境温度低于0℃。

防冻措施

- 在可能结冰的场所使用时，要切实做好防冻措施。
- 1. 产品结冰的话零件损坏，成为漏水的原因。
 - 2. 因结冰造成的零件破损即使在保修期也是有偿修理。
 - 3. 施工完了后或长时间不使用时，要有预防突然降温的准备，要对产品进行结冰预防。
 - 4. 因为有结冰的危险，请不要让产品周围的温度在0℃以下。

保养

- 为长期保持产品的美观，请用户按以下方法维护保养。
- 1. 经常用软布擦拭，间或用软布蘸水擦拭。
 - 2. 当有污垢且比较明显时，请用中性洗涤剂擦拭后充分进行水洗。

安装完成图

DP354 铜合金壁式单柄暗装单向转换面板

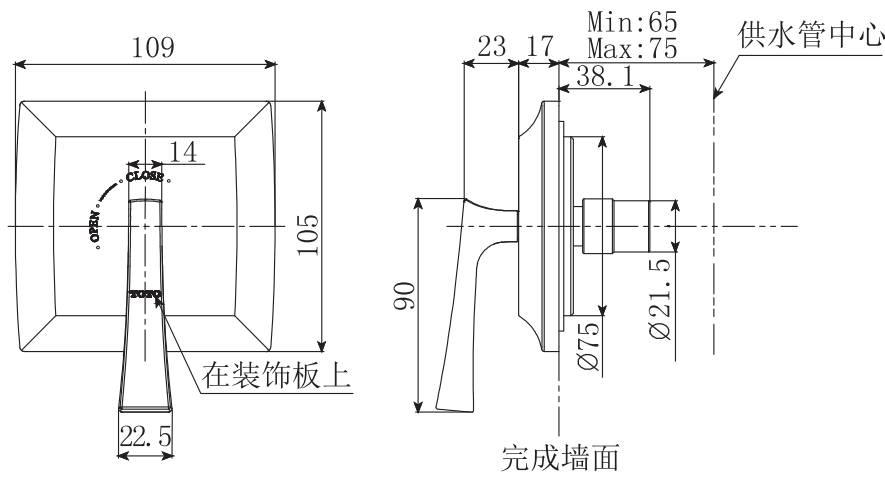

图中尺寸单位为:mm
DP354与DV105R配合使用

安装完成图

DP355 铜合金壁式单柄暗装双向转换面板

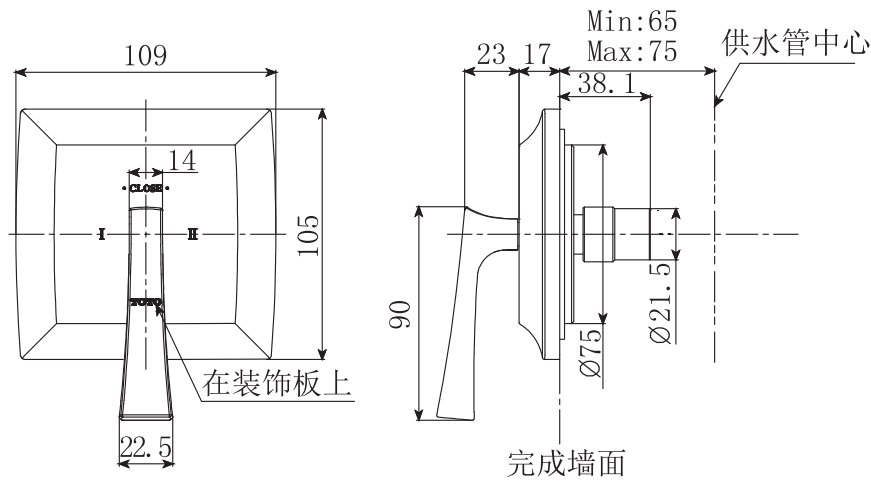

图中尺寸单位为:mm
DP355与DV104配合使用

安装完成图

DP357 铜合金壁式单柄暗装双向转换面板

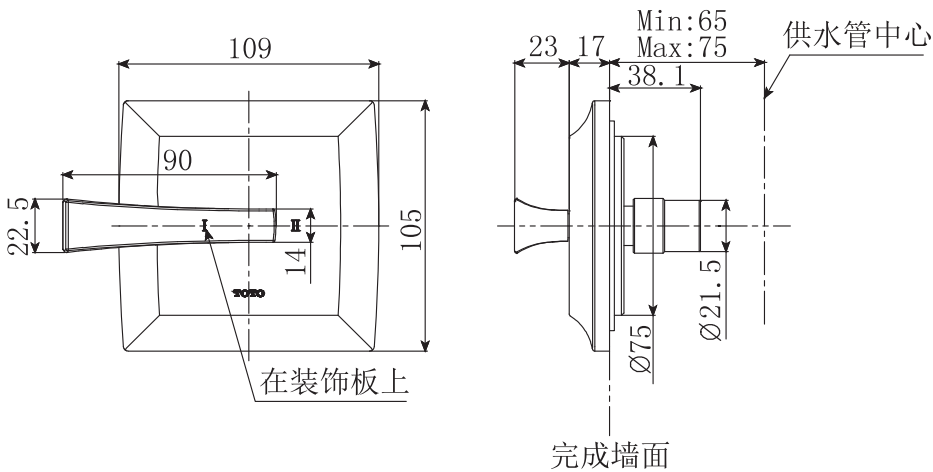

图中尺寸单位为:mm
DP357与DV357配合使用

安装完成图

DV104 铜合金壁式单柄暗装双向转换阀体(开闭切换)

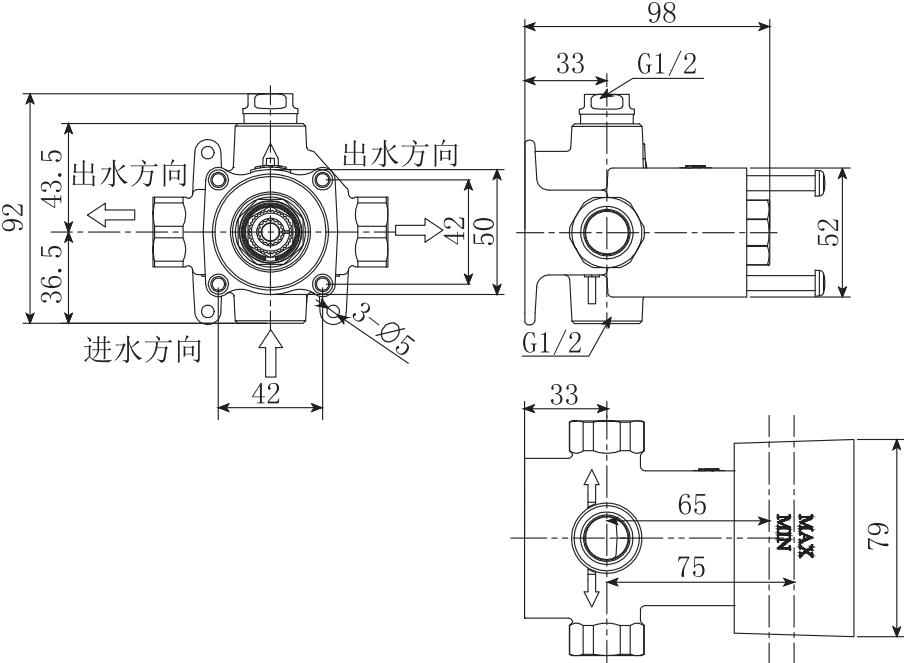

DV104-1R系列水嘴

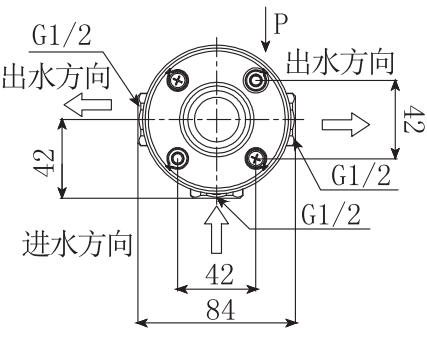

图中尺寸单位为:mm
DV104与DP355配合使用

P视图

安装完成图

DV105R 铜合金壁式单柄暗装单向转换阀体(开闭切换)

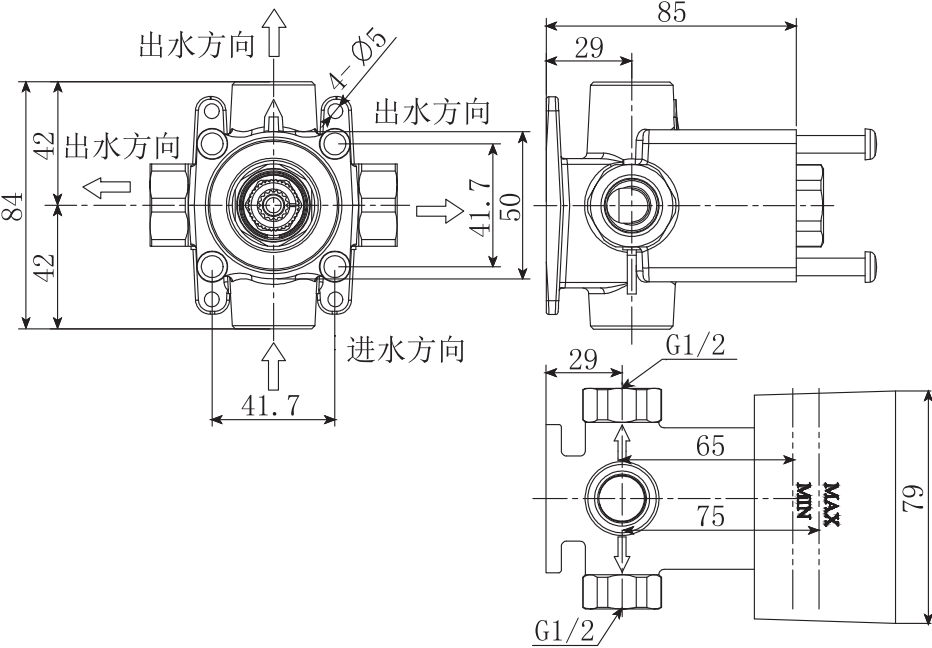

DV105-1 铜合金壁式单柄暗装单向转换阀体(开闭切换)

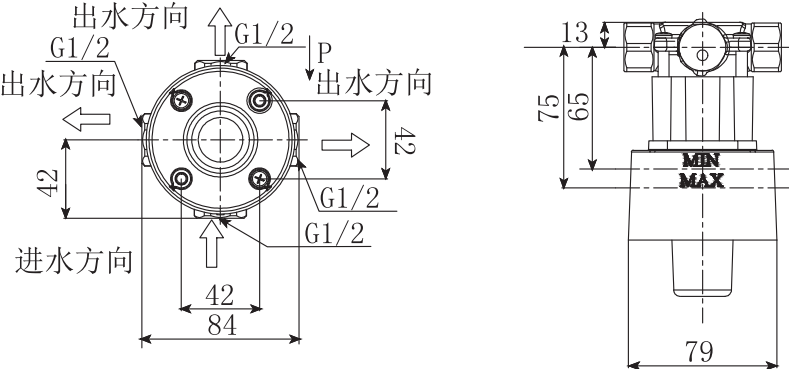

图中尺寸单位为:mm
DV105R与DP354配合使用

P视图

安装完成图

DV357 铜合金壁式单柄暗装双向转换阀体

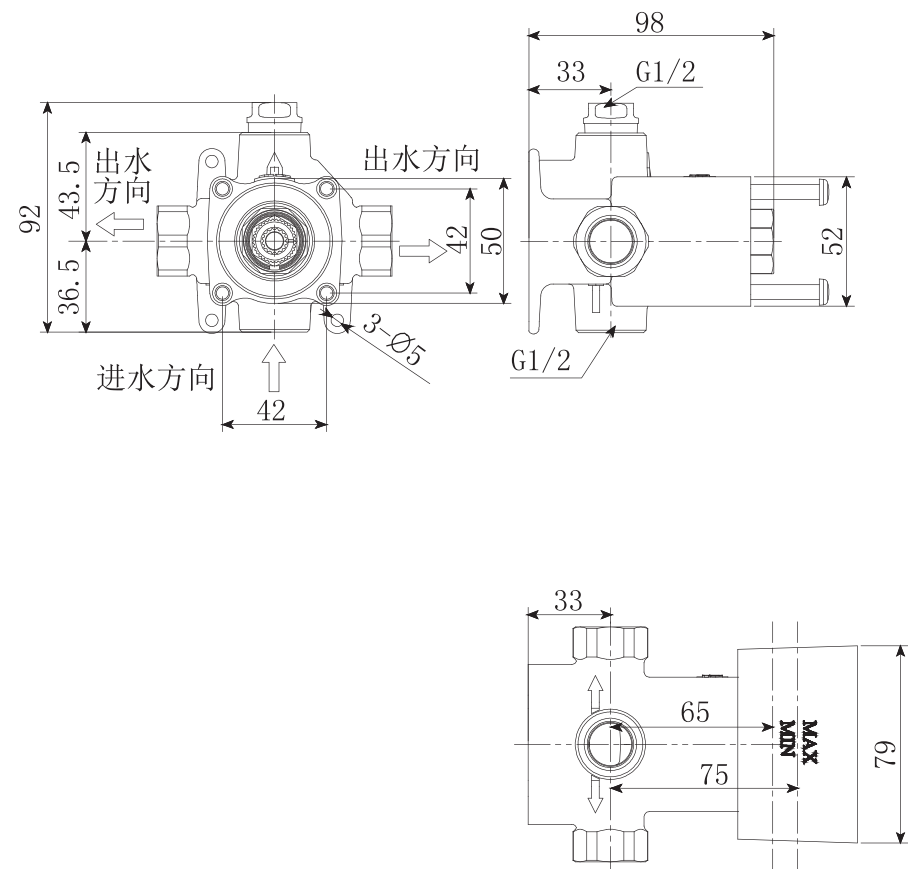

图中尺寸单位为：mm
DV357与DP357配合使用

水嘴的安装

DV104-1R 系列安装方法

需要准备的工具

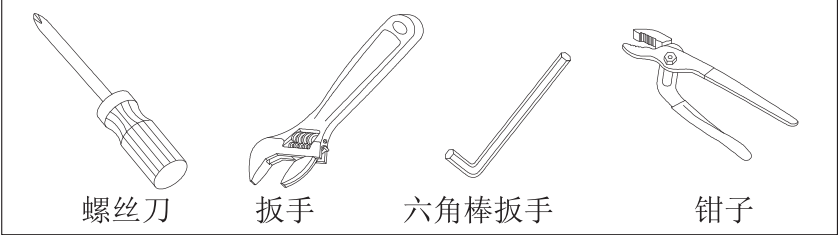

- 确认供水管已经关闭。
- 仔细阅读安装说明书并按照说明书的安装要领来进行安装。
- 确认您所看到包装盒内的部件同下图相同。

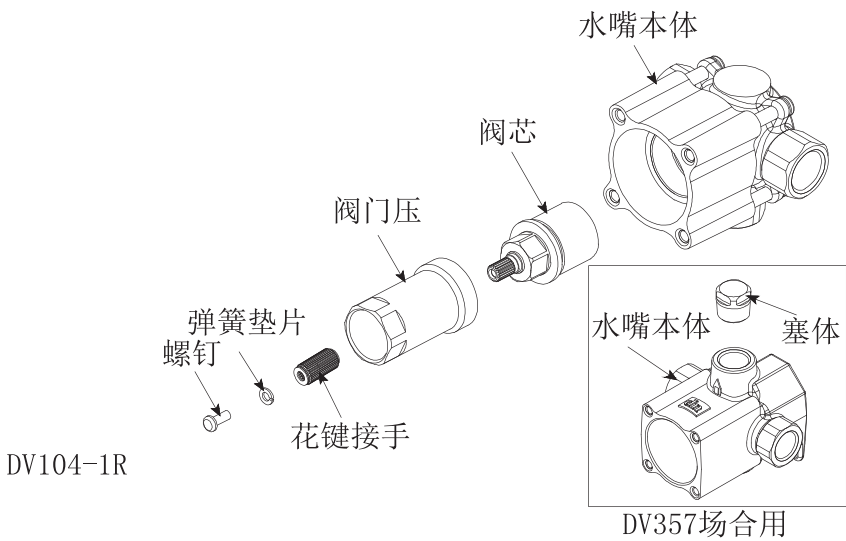

※DV105-1、DV105R、DV357与DV104-1R部件基本相同。

水嘴的安装

DV104-1R 系列安装方法

- 1、把本体与相应的管子连接好，然后比照产品形状在墙面开槽；

⚠ 注意：安装前务必试水，以防漏水等不良，产品应与墙面保持垂直。

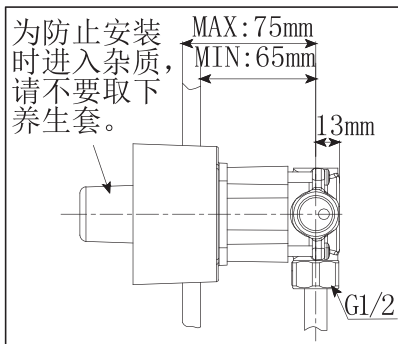

- 2、将DV104-1R中所带养生套取下，然后将面板配合，并用螺钉固定。

⚠ 注意：本体安装方向，箭头向上。

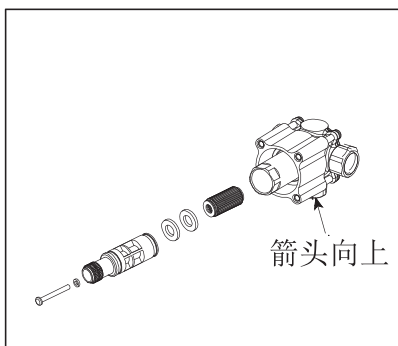

- 3、将装饰套安装上，螺钉对角固定本体上。

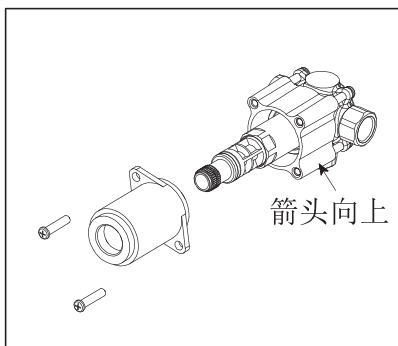

(DV105-1、DV105R、DV357安装方法与之相同)

水嘴的安装

DV104-1R 系列安装方法

- 4、将固定板安装上，螺钉对角固定在本体上剩余的螺钉孔内。

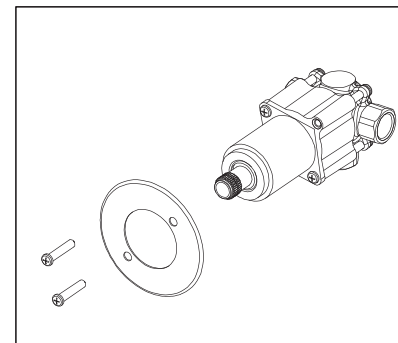

- 5、装饰板直接套在装饰套上压紧，与墙面紧贴。

⚠ 注意：为方便装饰板套入，可将装饰板内的O型圈涂布适量的肥皂水

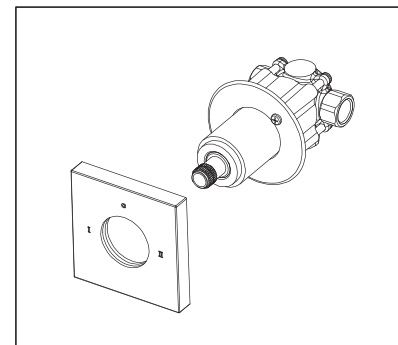

- 6、手柄安装上，将手柄旋转至关闭状态下，并保证手柄螺钉孔端朝下，旋转螺钉，最后安装表示盖。

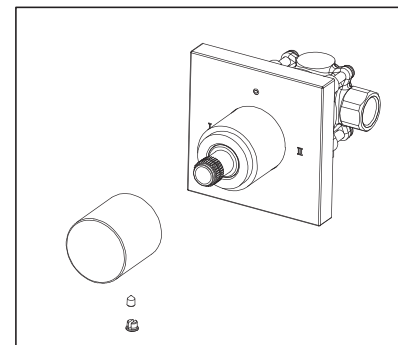

(DV105-1、DV357安装方法与之相同)

水嘴的安装

DP355、DV104 系列安装方法

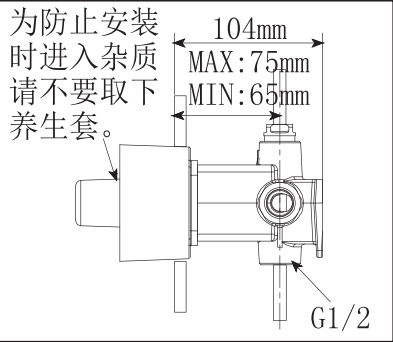

- 1、把本体与相应的管子连接好，然后比照产品形状在墙面开槽；

⚠ 注意：安装前务必试水，以防漏水等不良，产品应与墙面保持垂直

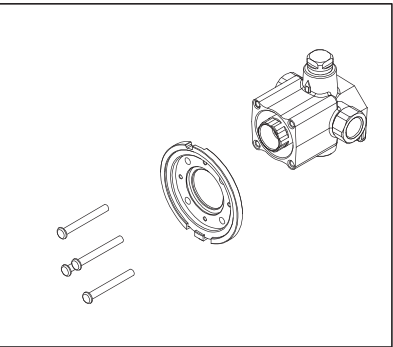

- 2、将养生套取下，用四个长螺钉将固定板安装在本体上，并与墙面紧贴。

⚠ 注意：本体安装方向，箭头向上

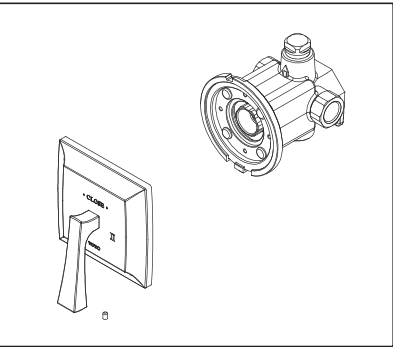

- 3、将装饰板部安装上, 标识向上。
先将装饰板部手柄朝下插入阀芯部, 轻轻旋转装饰板(手柄不动), 将装饰板与固定板扣合, 最后用六角扳手将小螺钉旋入装饰板中, 使之固定。(DP357场合, 手柄水平放置插入阀芯部。)

(DP354、DV105R、DP357、DV357安装方法与之相同)

生产厂家与销售商

执行标准：GB 18145-2014

产品型号：见包装箱上的标签

产品名称：见包装箱上的标签

生产日期：见包装箱上的标签

组装工厂：东陶(大连)有限公司

电 话：(0411)87624383

厂 址：大连经济技术开发区东北二街17号

东陶(中国)有限公司

全国售后服务电话：800-820-9787(固定电话)
400-820-9787(手机用户)

销售商：东陶(中国)有限公司

地 址：北京市朝阳区光华路1号 北京嘉里中心北楼1915室

网 址：www.toto.com.cn

Contents

Contents	
Contents.....	1
Detailed list.....	2-3
Service condition and attentions in construction	4
Attentions in construction and Maintenance	5
Installation completion figure	6-11
Water nozzle installation	12-15
Manufacturer and vendor.....	16

Detailed list

Detailed list	
Body part	1 set
Instructions for construction.....	1 copy
Instructions for operation	1 copy
The products using this detailed list include:	
DV104 Copper alloy wall type single-handle bidirectional changeover valve body(switching between opening and closing)	
DV105R Copper alloy wall type single-handle one-way changeover valve body(switching between opening and closing)	
DV105-1 Copper alloy wall type single-handle one-way changeover valve body(switching between opening and closing)	
DV357 Copper alloy wall type single-handle bidirectional changeover valve body	
DV104-1R Copper alloy wall type single-handle bidirectional changeover valve body(switching between opening and closing)	
DP355 Series water tap panel part should be used with DV104 series water tap body part.	
DP354 Series water tap panel part should be used with DV105R series water tap body part.	
DP357 Series water tap panel part should be used with DV357 series water tap body part	

Detailed list



Detailed list	
Panel part	1set
Instructions for construction	1 copy
Instructions for operation.....	1 copy
The products using this detailed list include:	
DP354 Copper alloy wall type single-handle concealed one-way changeover panel	
DP355 Copper alloy wall type single-handle concealed bidirectional changeover panel(switching between opening and closing)	
DP357 Copper alloy wall type single-handle concealed bidirectional changeover panel	

Service condition and attentions in construction

Use condition

1. Cold water supply*hot water supply pressure
Minimum pressure 0.05MPa (flow pressure)
Maximum pressure 1.0MPa (static pressure)
2. The temperature for water supply is 4~90℃. It is suggested to use the hot water temperature 60±5℃, Do not use steam to supply hot water.
3. The ambient temperature for use is above 0℃. If not, the water tap may deform and crack due to freezing.
4. To prevent internal sprinkler damage,the water outlet temperature on the sprinkler side shall not exceed 60℃.It is suggested to use a temperature below 45℃.
5. Being out of use for a long time may result in internal and external rust to the water nozzle and being unable to be used.
6. If you want to scrap this product, do not treat it as you do for general dometic grabage. Please follow relevant statutes to have it treated, recovered and collected appropriately by an independent recovery system.
7. The product in these instructions has a cleaning function.

Attentions in using

-  **Warning:**it means that ignoring this mark and misoperation may cause serious personal injury and death.
-  **Attention:** it means that ignoring this mark and misoperation may cause personal injury or property loss.

Warning

1. The hot water supply side of the water nozzle is in a condition of high temperature. Do not allow skin to contact with the hardware surface directly. Otherwise, scalding may happen.
2. Do not reverse the cold*hot water pipes. Otherwise scalding may occur.
3. Do not use steam to supply hot water. Otherwise, scalding may occur.
4. If a customer fails to use the self-contained water inlet filter net of our water faucet, there is such a risk as water leakage or damage due to foreign matters entering into the spool.
5. In constuction,do not install and use the G1/2 or G3/4 internal threads of this product with R1/2 or R3/4 connector. Otherwise,the main body threads may crack,resulting in such quality problems as water leakage,etc.

Attentions in construction and Maintenance

Attentions

1. As the ceramic spool is a precise component, do not dismantle it without authorization. Otherwise, such poor conditions as water leakage, etc. may be caused.
2. Do not impact the product. Otherwise, failure, water leakage may occur.
3. With the product design being updated constantly, the physical object may not coincide with the figure. However, the basic principle for installation, use is the same.
4. When using in places where icing may occur, anti-freezing measures must be taken. The parts will be damaged due to icing, which may cause water leakage and property loss. Damages caused by icing are repaired for a fee even during the warranty period. Please ensure that the ambient temperature of the product is always above 0°C.

Anti-freezing measures

When using in places where icing may occur, anti-freezing measures must be taken.

1. The parts will be damaged due to icing, which may cause water leakage.
2. Damaged parts caused by icing are repaired for a fee even during the warranty period.
3. After the construction is completed or when it is not used for a long time, prepare to prevent sudden drop of temperature and prevent the product from icing.
4. Because of the risk of icing, please ensure that the ambient temperature of the product is always above 0°C.

Maintenance

To maintain a beautiful appearance of the product, the user is requested to conduct maintenance and care in the following method.

1. Wipe with a piece of soft cloth frequently and use a piece of soft cloth dipped in water to wipe from time to time.
2. When dirt exists obviously, please use water to wash sufficiently after wiping with a neutral detergent.

Installation completion figure

DP354 Copper alloy wall type single-handle concealed one-way changeover panel

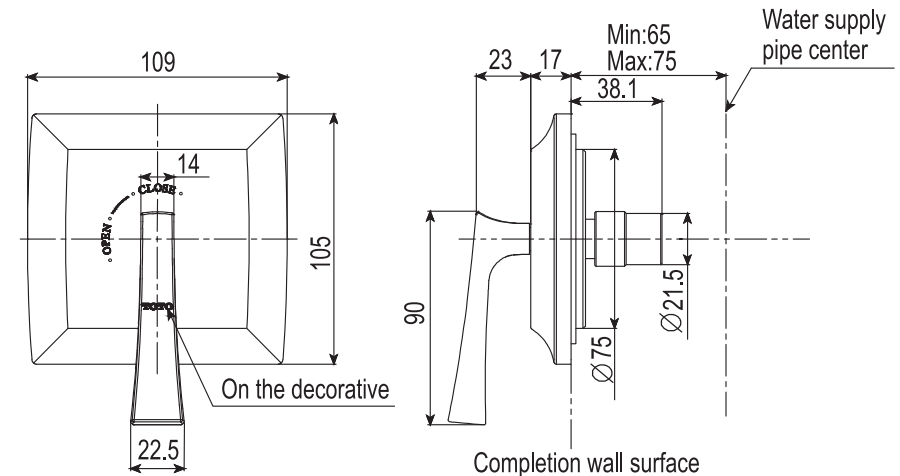

Note: The above dimensional unit is mm.
DP354 should be used with DV105R.

Installation completion figure

DP355 Copper alloy wall type single-handle concealed bidirectional changeover panel (switching between opening and closing)

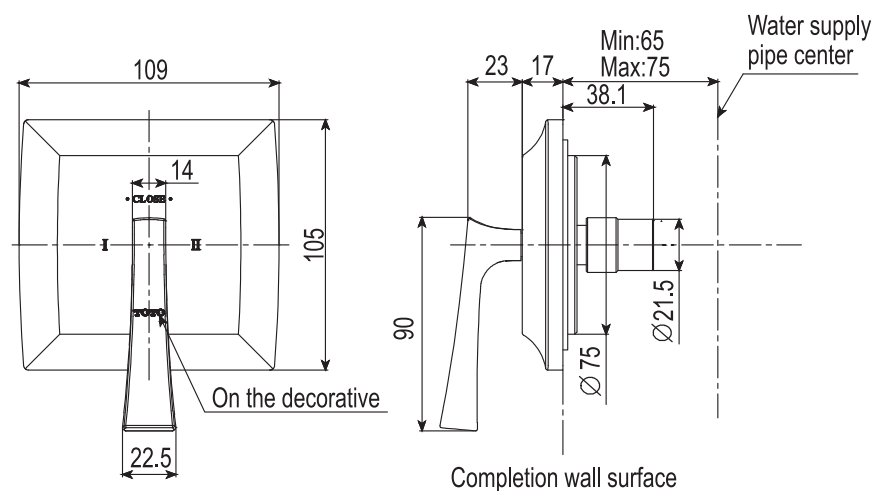

Note: The above dimensional unit is mm.
DP355 should be used with DV104.

Installation completion figure

DP357 Copper alloy wall type single-handle concealed bidirectional changeover panel

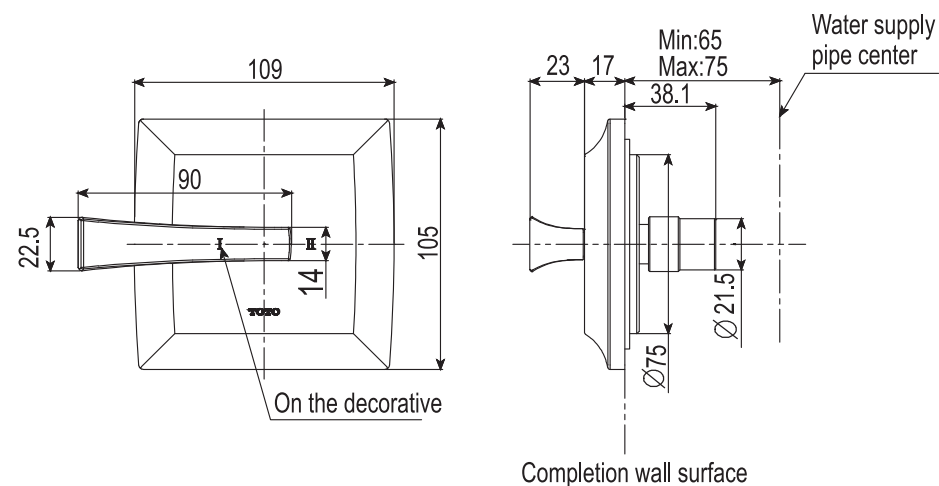

Note: The above dimensional unit is mm.
DP357 should be used with DV357.

Installation completion figure

DV104 Copper alloy wall type sing-handle bidirectional changeover valve body (switching between opening and closing)

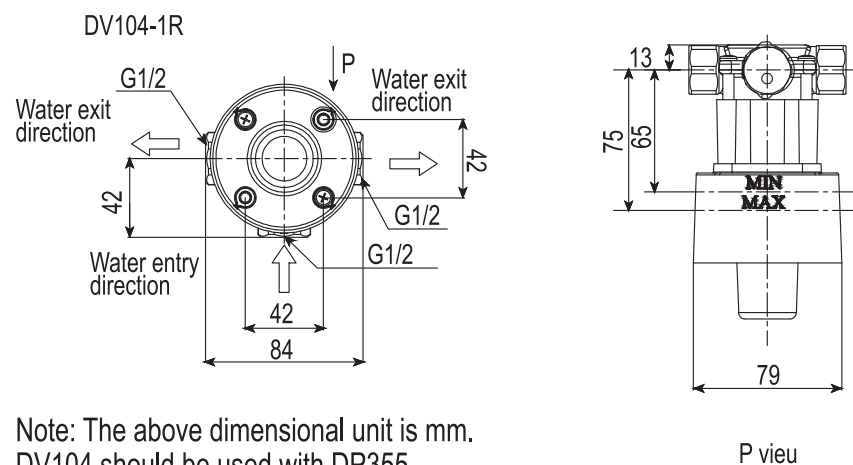
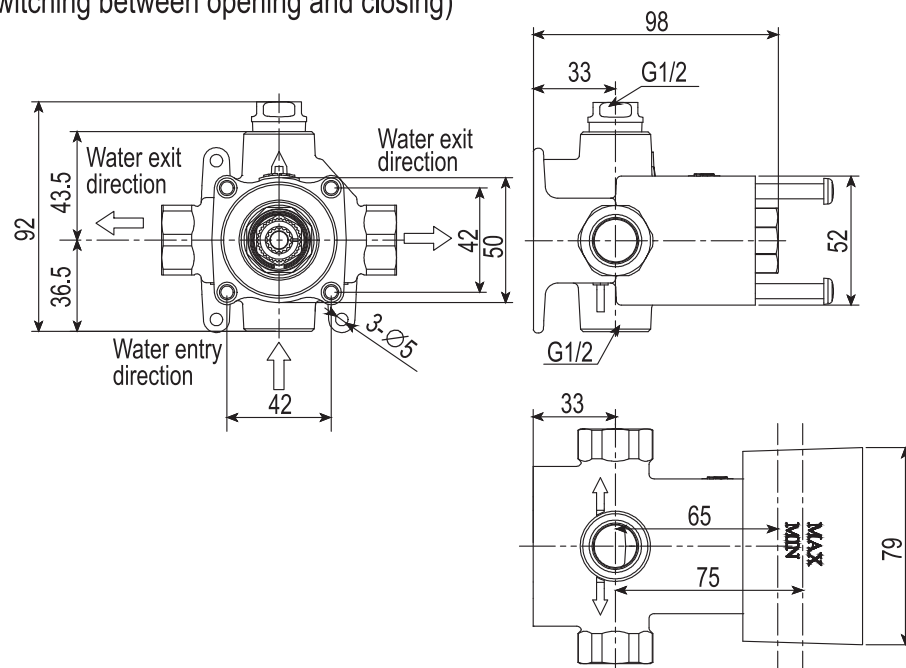

Note: The above dimensional unit is mm.
DV104 should be used with DP355.

Installation completion figure

DV105R Copper alloy wall type sing-handle one-way changeover valve body (switching between opening and closing)

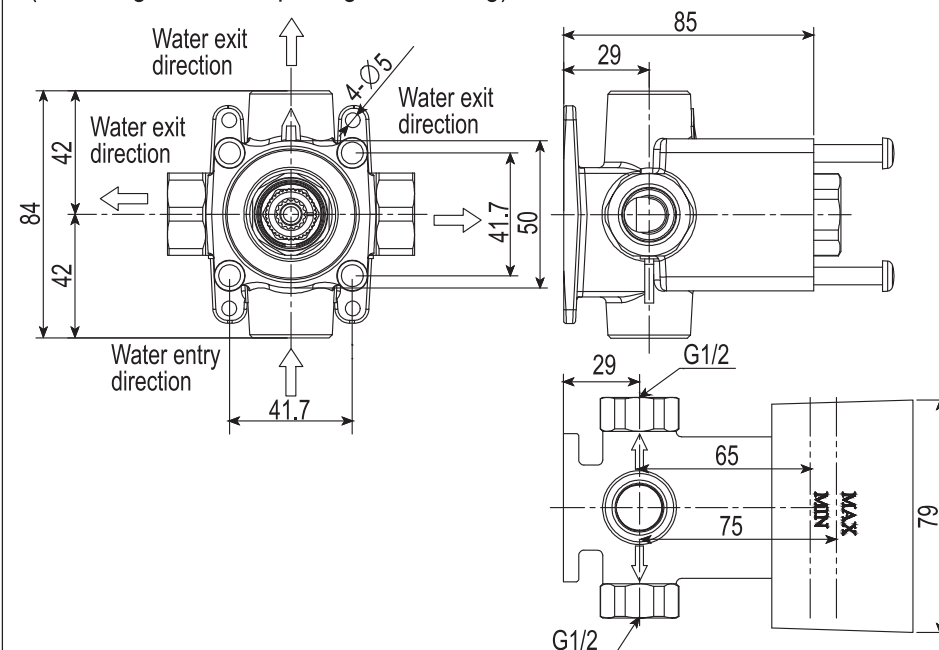

DV105-1 Copper alloy wall type sing-handle one-way changeover valve body (switching between opening and closing)

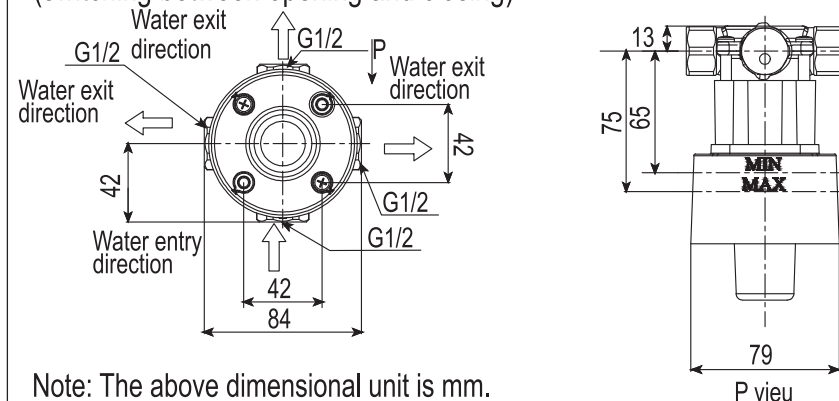

Note: The above dimensional unit is mm.
DV105R should be used with DP354.

Installation completion figure

DV357 Copper alloy wall type sing-handle bidirectional changeover valve body (switching between opening and closing)

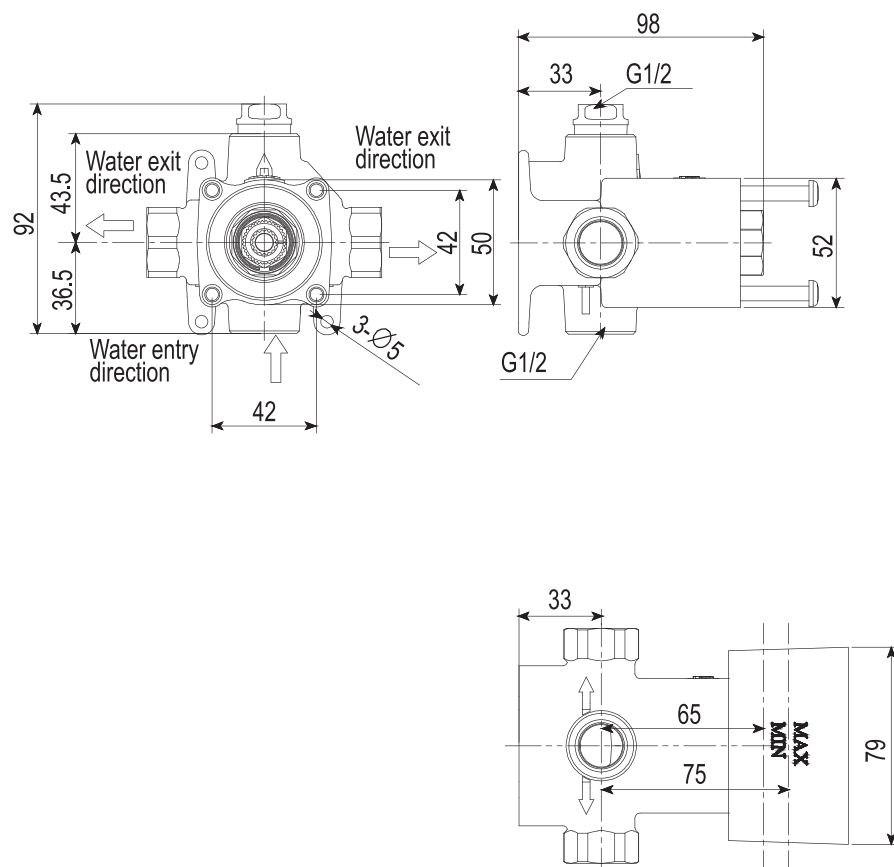

Note: The above dimensional unit is mm.
DV357 should be used with DP357 .

Water nozzle installation

DV104-1R series installation method

Tools to be prepared

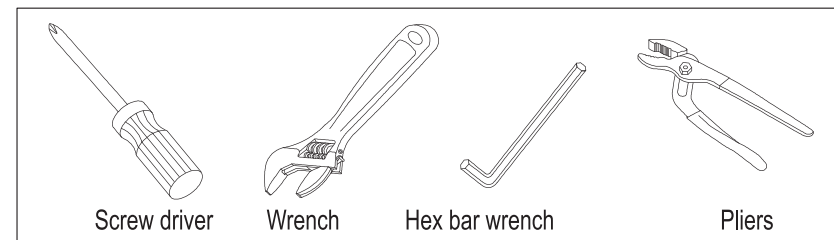

- Confirm that the water supply pipe has been closed.
- Read carefully the instructions for installation and install according to the main installation points therein.
- Confirm that the components you have seen in the packing box are identical to the following figure.

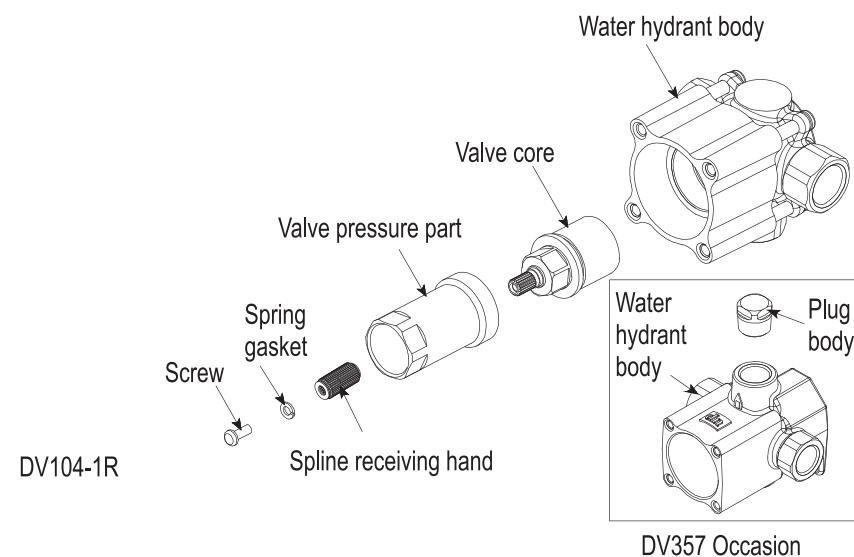

The components of DV105-1,DV105R,DV357 and DV104-1R are basically the same.

Water nozzle installation

DV104-1R series installation method

1. Connect the body and corresponding pipe properly. Then cut a slot on the wall surface by referring to the product shape

⚠ Attention

Be sure to make a water test before installation to prevent water leakage, etc. The product shall be kept perpendicular to the wall surface.

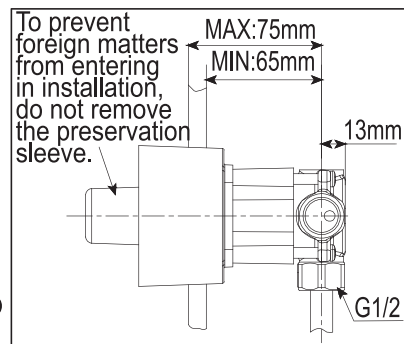

2. Remove the preservation sleeve and the short spline receiving hand that the original DV104 has together. Replace with the long spline receiving hand of DP347. Then put the long receiving hand on and fix by using screws

⚠ Attention

The body installation direction arrow faces up.

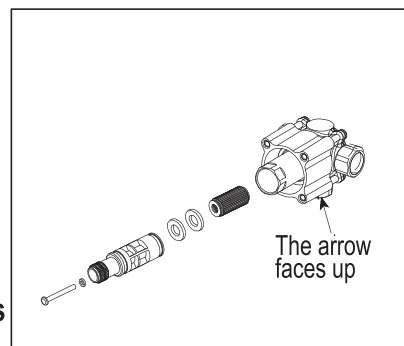

3. Install the decorative cover and fix the screws onto the body diagonally.

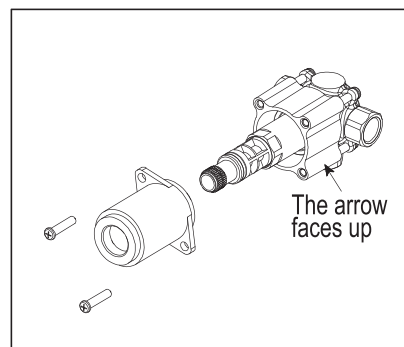

The installation method for DV105-1, DV105R, DV357 is the same

Water nozzle installation

DV104-1R series installation method

4. Install the fixing plate and fix the screws in the screw holes remaining on the body diagonally.

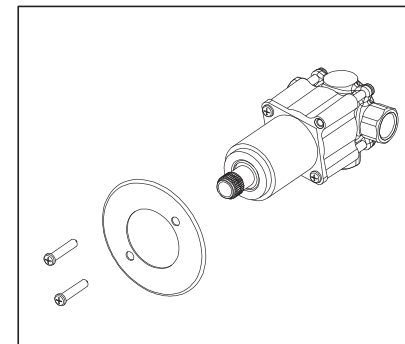

5. Put the decorative plate on the decorative sleeve directly and compress tight to fit closely with the wall surface.

⚠ Attention

To facilitate the decorative plate to be put on, apply appropriate amount of soap water on the O-ring in the decorative plate.

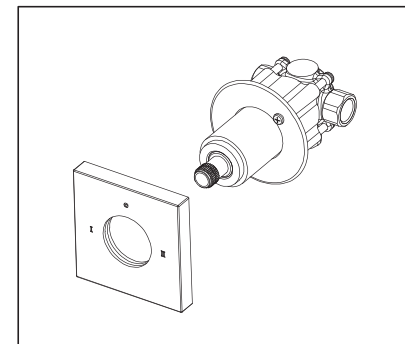

6. Install the handle and turn the handle to the closing state and keep the handle screw hole end facing down. Screw tight the screws and finally install the indicating cover.

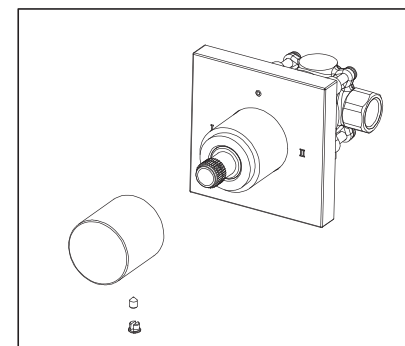

The installation method for ,DV105R,DV105-1,DV357 is the same

Water nozzle installation

DP355、DV104 series installation method

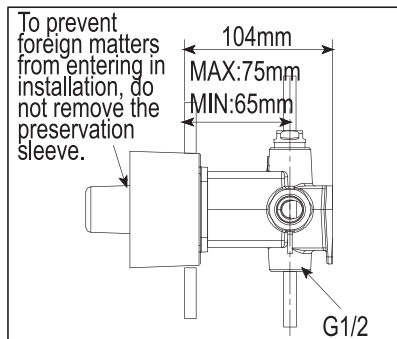

1. Connect the body and corresponding pipe properly. Then cut a slot on the wall surface by referring to the product shape

⚠️ Attentions

Be sure to make a water test before installation to prevent water leakage, etc. The product shall be kept perpendicular to the wall surface.

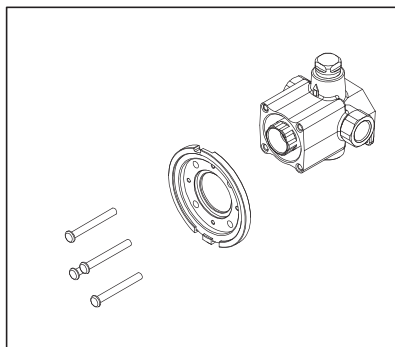

2. Remove the preservation sleeve and use four long screws to fix the fixing plate onto the body and fit closely with the wall surface.

⚠️ Attentions

The body installation direction arrow faces up.

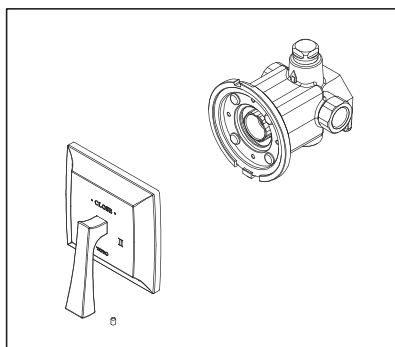

3. Install the decorative plate with the identification facing up. First insert the handle of the decorative plate part in the valve core part downward. Rotate the decorative plate gently (the handle do not move). Snap-fit the decorative plate and fixing plate. Finally, use a hex wrench to screw the small screw in the decorative plate to fix it. (In case of DP357, place the handle horizontally to have it inserted in the valve core part.)

The installation method for DP354, DV105R, DP357, DV357 is the same

Manufacturer and vendor

Applicable standard: GB 18145-2014

Product Model No.: See the label on the packaging case

Product name: See the label on the packaging case

Production date: See the label on the packaging case

Assembly factory: TOTO(Dalian)Co., Ltd.

Telephone: (0411)87624383

Factory address: 17 Dong Bei Second Street, Economic & Technical Development Zone, Dalian

TOTO(China)Co., Ltd.

After-sale service toll free telephone all over the country:

800-820-9787 (fixed telephone)

400-820-9787 (for mobile phone users)

Vendor: TOTO(China)Co., Ltd.

Address: Room 1915, North Building of Beijing Jiali Center,

No. 1, Guanghua Road, Chaoyang District, Beijing

Website: www.toto.com.cn