

# 施工说明书 Instructions for construction

安装产品前请仔细阅读本施工说明书，并保留备用。  
Before product installation, read these instructions for  
construction carefully and retain it for future reference.

# TOTO

# TOTO

OG3511Y(B)  
2021.06

# 目录

## 目 录

目 录.....	1
明细单.....	2
使用上的条件与施工上的注意...	3
施工上的注意和保养 .....	4
安装完成图.....	5
水嘴的安装.....	6-8
生产厂家与经销商.....	9

# 明细单

## 明细单

面 板 部.....	1套
手 柄 部.....	1套
连接套部.....	1套
施工说明书.....	1本
使用说明书.....	1本

使用此明细单的产品包括：

DP422      单柄恒温淋浴暗装普通水压水嘴面板  
DP422#PG   单柄恒温淋浴暗装普通水压水嘴面板

# 使用条件与施工上的注意

## 使用条件

1. 供冷水\*热水压力:  
最低压力.....0.05MPa (流动压)  
最高压力.....0.5MPa (流动压)  
推荐使用压力.....0.1-0.5MPa (流动压)  
超过0.5MPa要加装减压阀。
2. 冷水温度4℃~29℃、热水温度45℃~85℃, 建议正常使用热水温度为50℃~75℃, 供热水请勿使用蒸汽。
3. 使用环境温度0℃以上。如果低于0℃, 水嘴会出现变形、冻裂等现象。
4. 为防止花洒内部损坏, 花洒侧吐水温度不得超过60℃, 建议使用温度45℃以下。
5. 长时间不使用时, 可能导致水嘴内部及外部锈蚀不能使用等现象。
6. 如果您需要废弃本产品, 请勿将其作为一般生活垃圾处理, 请依照法规经由独立的回收体系进行合适的处理、恢复和回收。
7. 本说明书中的产品具有清洗功能。

## 施工上的注意

- ⚠警告** 表示如果无视此标志而误操作时, 有可能造成人员重伤或死亡。
- ⚠注意** 表示如果无视此标志而误操作时, 有可能造成人身伤害或财产损失。

### ⚠警告

1. 水嘴的供热水一侧处于高温状态, 请注意勿使皮肤直接接触五金配件表面, 否则可能会烫伤。
2. 请勿配反冷\*热水配管, 否则可能会烫伤。
3. 供热水请勿使用蒸汽, 否则可能会烫伤。
4. 使用前, 要用手测试水温后再使用, 否则可能会烫伤。
5. 慢慢地旋转温度调节手柄, 若急速地转动温度调节手柄, 温度会骤然上升或下降。
6. 如果客户不使用我司水嘴自带的进水口过滤网, 可能会出现阀芯因异物进入而导致的漏水或破损的风险。
7. 温度调节手柄上的安全按钮与装饰板“38”或与“○”的标记居中对齐时, 出水温度为38℃; 温度调节手柄逆时针旋转 (按安全按钮) 至转不动时, 出水温度为42℃左右。使用了热水后必须将温度调节手柄调到“38”以免再使用时又喷出热水造成烫伤。

# 施工上的注意和保养

8. 产品不可在0℃以下的环境使用, 否则会因结冰, 阀芯失灵导致烫伤。一旦发生结冰, 要确认温度调节手柄在刻度“38”时的吐水温度。结冰会使设定的温度发生偏差, 有烫伤的危险。

## ⚠注意

1. 由于温控阀芯是较精密的部件, 请勿擅自分解, 否则可能会造成漏水等不良。
2. 请勿撞击本产品, 否则可能会造成故障、漏水。
3. 必须使用中性洗涤剂清洗, 中性以外的洗涤剂会破坏镀层或使表面变色。
4. 不得使用酸性洗涤剂和去污粉、抛光粉等含粗颗粒的洗涤剂和尼龙刷, 否则可能会破坏镀层等。
5. 可使用软布擦拭, 间或用机油或车用蜡浸布擦拭, 但请勿接触树脂部件, 否则可能失去光泽和产生锈蚀。
6. 建议不要长时间不使用, 否则可能会导致水嘴内部以及外部锈蚀不能使用等现象。
7. 随着产品式样的不断更新, 实物存在与图示不符的情况, 但基本安装、使用原理相同。
8. 由于出厂前进行通水检查, 故水嘴内可能有残漏水, 并非产品有问题。
9. 在可能结冰的场所使用时, 要切实做好防冻措施。因结冰, 零件破损, 有可能导致漏水, 造成财产损失。因结冰而造成的破损即使在保修期内也是有偿修理。请不要让产品的环境温度低于0℃。

## 防冻措施

- 在可能结冰的场所使用时, 要切实做好防冻措施。
1. 产品结冰的话零件损坏, 成为漏水的原因。
  2. 因结冰造成的零件破损即使在保修期也是有偿修理。
  3. 施工完了后或长时间不使用时, 要有预防突然降温的准备, 要对产品进行结冰预防。
  4. 因为有结冰的危险, 请不要让产品周围的温度在0℃以下。

## 保养

- 为长期保持产品的美观, 请用户按以下方法维护保养。
1. 经常用软布擦拭, 间或用软布蘸水擦拭。
  2. 当有污垢且比较明显时, 请用中性洗涤剂擦拭后充分进行水洗。

# 安装完成图

DP422 单柄恒温淋浴暗装普通水压水嘴面板

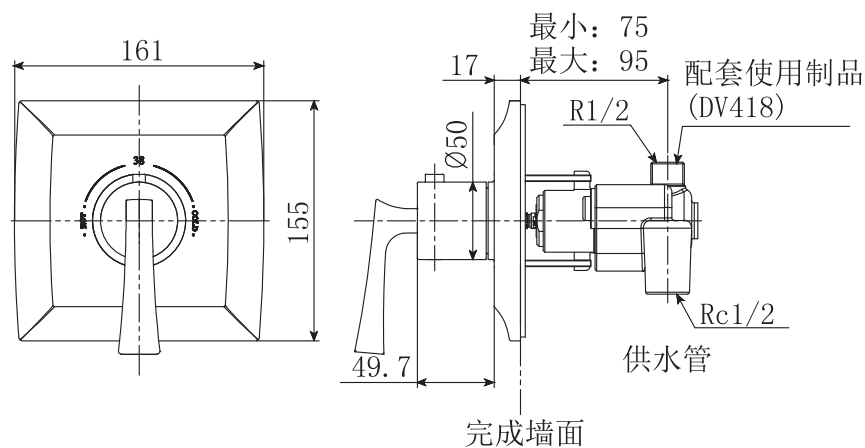

注：上記尺寸单位为mm  
( ) 内尺寸为参考尺寸

# 水嘴的安装

需要准备的工具

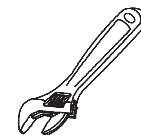

扳手

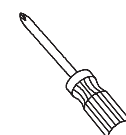

十字花螺丝刀



六角棒扳手

- 确认供水管已经关闭
- 仔细阅读安装说明书并按照说明书的安装要领来进行安装。
- 确认您所看到包装盒内的部件同下图相同。

DP422

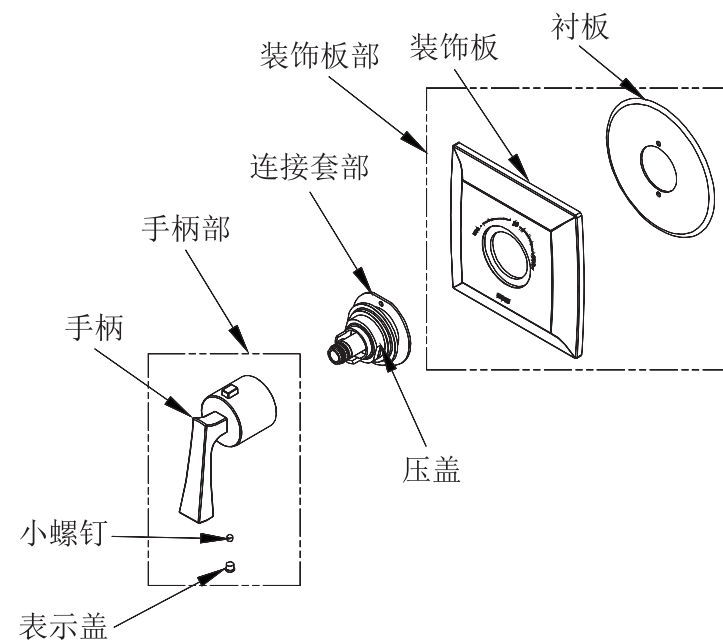

# 水嘴的安装

DV418安装好后，将养生套取下，然后将DP422的衬板套在DV418上扣在墙面上，把连接套部（※连接套部的切口方向向上）用紧固养生套的螺钉紧固在衬板上，装饰板部扣在连接套部上，再用压盖用力紧固住，最后用小螺钉将手柄固定住，安装好表示盖。

注意：

- A、各个零件的位置（手柄部上的安全按钮要与装饰板上的“38”标记对齐）拧紧小螺钉。
- B、水龙头吐水温度在出厂时已设定好为“38℃”，请客户在安装时不要旋转DV418的花键接手。

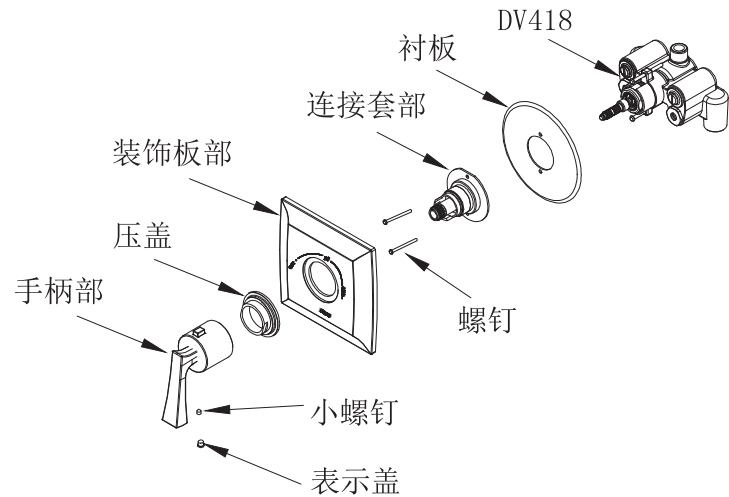

# 水嘴的安装

温度调节

水龙头在工厂中已作调节，但是因安装现场的压力状态等原因，有时会达不到刻度的出水温度，因此请按下列要领进行调节。调节之前请确认好下列事项。

止水阀是否全部打开。

滤网是否被灰尘堵塞。

热水是否达到足够的温度（比使用温度高10℃以上）。

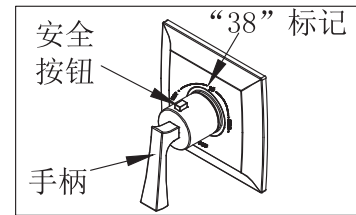

调节要领

让吐水口吐水，旋转手柄直至出水温度达到38℃。（旋转至高温侧时，请按安全按钮）

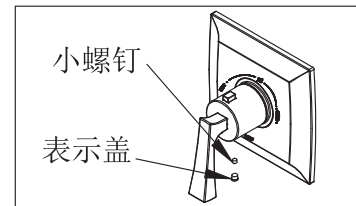

取下表示盖，请用准备好的六角棒扳手拆下小螺钉。不要使手柄旋转。

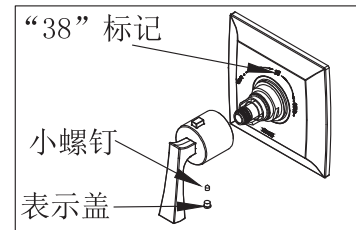

将手柄上的安全按钮和装饰板上的“38”标记相对齐，将手柄装上，拧紧小螺钉，盖上表示盖。

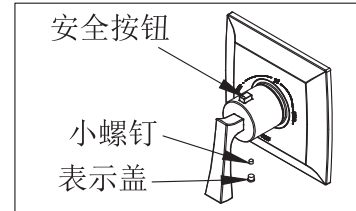

固定后再次确认出水温度是否是38℃。

# 生产厂家与销售商

执行标准: QB/T 2806-2017

产品型号: 见包装箱上的标签

产品名称: 见包装箱上的标签

生产日期: 见包装箱上的标签

组装工厂: 东陶(大连)有限公司

电 话: (0411) 87624383

厂 址: 大连经济技术开发区东北二街17号

东陶(中国)有限公司

全国售后服务电话: 800-820-9787(固定电话)

400-820-9787(手机用户)

销售商: 东陶(中国)有限公司

地 址: 北京市朝阳区光华路1号 北京嘉里中心北楼1915室

网 址: [www.toto.com.cn](http://www.toto.com.cn)

# Contents

## Contents

Contents..... 1

Detailed list.....2

Use condition and attentions in  
construction .....3

Attentions in construction and  
maintenance ..... 4-5

Installation completion figure ..... 6

Water nozzle installation ..... 7-9

Manufacturer and vendor..... 10

## Detailed list

### Detailed list

Panel part .....	1 set
Handle part .....	1 set
Connecting sleeve part .....	1 set
Instructions for construction.....	1 copy
Instructions for operation .....	1 copy

The products using this detailed list include:

- DP422 Concealed single handle thermostatic bath water nozzle with an ordinary water pressure
- DP422#PG Concealed single handle thermostatic bath water nozzle with an ordinary water pressure

## Use condition and attentions in construction

### Use condition

1. Cold water supply\*hot water supply pressure  
Minimum pressure ..... 0.05MPa (flow pressure)  
Maximum pressure..... 0.5MPa (flow pressure)  
Recomm ended pressure ..... 0.1-0.5MPa (flow pressure)  
A pressure-reducing valve has to be installed when exceeding 0.5MPa.
2. The cold water temperature is 4°C~29°C and the hot water temperature is 45°C~85°C.  
It is suggested that the normal temperature of hot water is 50°C~75°C., Do not use steam to supply hot water.
3. The ambient temperature for use is above 0°C. If not, the water tap may deform and crack due to freezing.
4. To prevent internal sprinkler damage, the water outlet temperature on the sprinkler side shall not exceed 60°C. It is suggested to use a temperature below 45°C.
5. Being out of use for a long time may result in internal and external rust to the water nozzle and being unable to be used.
6. If you want to scrap this product, do not treat it as you do for general domestic garbage. Please follow relevant statutes to have it treated, recovered and collected appropriately by an independent recovery system.
7. The product in these instructions has a cleaning function.

### Attentions in construction



**Warning:** it means that ignoring this mark and misoperation may cause serious personal injury and death.



**Attention:** it means that ignoring this mark and misoperation may cause personal injury or property loss.



### Warning

1. The hot water supply side of the water nozzle is in a condition of high temperature. Do not allow skin to contact with the hardware surface directly. Otherwise, scalding may occur.
2. Do not reverse cold\*hot water pipes. Otherwise, scalding may occur.
3. Do not use steam to supply hot water. Otherwise, scalding may occur.
4. Before use, use hand to feel the water temperature. Otherwise, scalding may occur.
5. Turn slowly the temperature adjusting handle. If the temperature adjusting handle is turned rapidly, the temperature may rise or reduce sharply.
6. If a customer fails to use the self-contained water inlet filter net of our water faucet, there is such a risk as water leakage or damage due to foreign matters entering into the spool.



## Attentions in construction and maintenance

7. When the safety button on the temperature adjustment handle aligns with the “38” or “O” marking on the decorating plate in the center, the water output temperature is 38°C; when the temperature adjustment handle rotates anticlockwise (press the safety button) until it can not rotate any longer, the water output temperature is around 42°C. After using hot water, it is imperative to adjust to “38” by using the temperature adjustment handle to avoid hot water spraying out again and causing scalding in reuse.
8. The product shouldn't be used in an environment below 0°C, otherwise valve core failure may be caused due to icing and you may get burned. In case of icing, please confirm the spouting water temperature when the temperature adjusting handle is at “38”. Icing will cause deviations in the set temperature, which may result in burns.

### Attentions

1. As the ceramic cartridge is a precise component, do not dismantle it without authorization. Otherwise, such poor conditions as water leakage, etc. may be caused.
2. Do not impact the product. Otherwise, failure, water leakage may occur.
3. It is imperative to use a neutral detergent in cleaning. Other detergents than a neutral one may damage the plating coat or make the surface discolor.
4. Do not use any such detergent as acidic detergent and abstrergent, polishing powder, etc. containing thick particles and nylon brush. Otherwise, the plating coat may be damaged, etc.
5. It is allowed to use a piece of soft cloth to wipe or use from time to time a piece of cloth immersed in machine oil or vehicle wax to wipe. However, do not contact with resin components. Otherwise, they may lose the gloss and become rusty.
6. It is suggested not to leave it unused for a long time. Otherwise, this may lead to internal and external rust to water nozzle to such a degree that it cannot be used any more, etc.
7. With the product design being updated constantly, the physical object may not coincide with the figure. However, the basic principle for installation, use is the same.
8. As water supply inspection is made before leaving the factory, there may be some water left in the water faucet. This is not a problem of the product.
9. When using in places where icing may occur, anti-freezing measures must be taken. The parts will be damaged due to icing, which may cause water leakage and property loss. Damages caused by icing are repaired for a fee even during the warranty period. Please ensure that the ambient temperature of the product is always above 0°C.

## Attentions in construction and maintenance

### Anti-freezing measures

When using in places where icing may occur, anti-freezing measures must be taken.

1. The parts will be damaged due to icing, which may cause water leakage.
2. Damaged parts caused by icing are repaired for a fee even during the warranty period.
3. After the construction is completed or when it is not used for a long time, prepare to prevent sudden drop of temperature and prevent the product from icing.
4. Because of the risk of icing, please ensure that the ambient temperature of the product is always above 0°C.

### Maintenance

To maintain a beautiful appearance of the product, the user is requested to conduct maintenance and care in the following method.

1. Wipe with a piece of soft cloth frequently and use a piece of soft cloth dipped in water to wipe from time to time.
2. When dirt exists obviously, please use water to wash sufficiently after wiping with a neutral detergent.



# Installation completion figure

DP422 Concealed single handle thermostatic bath water nozzle with an ordinary water pressure

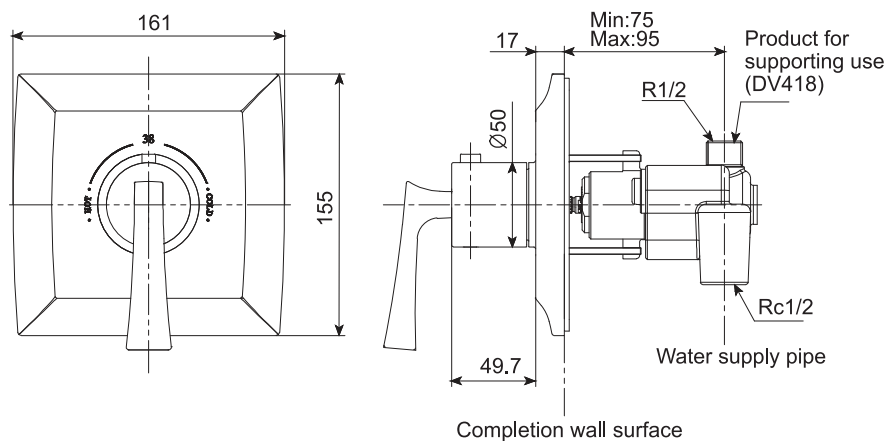

Note: The above dimensional unit is mm.  
The dimensions in ( ) are reference ones.

# Water Nozzle Installation

Tools to be prepared

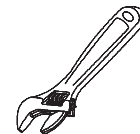

Wrench

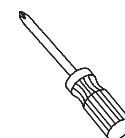

Phillips screwdriver



Hex bar wrench

- Confirm that the water supply pipe has been closed.
- Read carefully the instructions for installation and install according to the main installation points therein.
- Confirm that the components you have seen in the packing box are identical to the following figure.

DP422

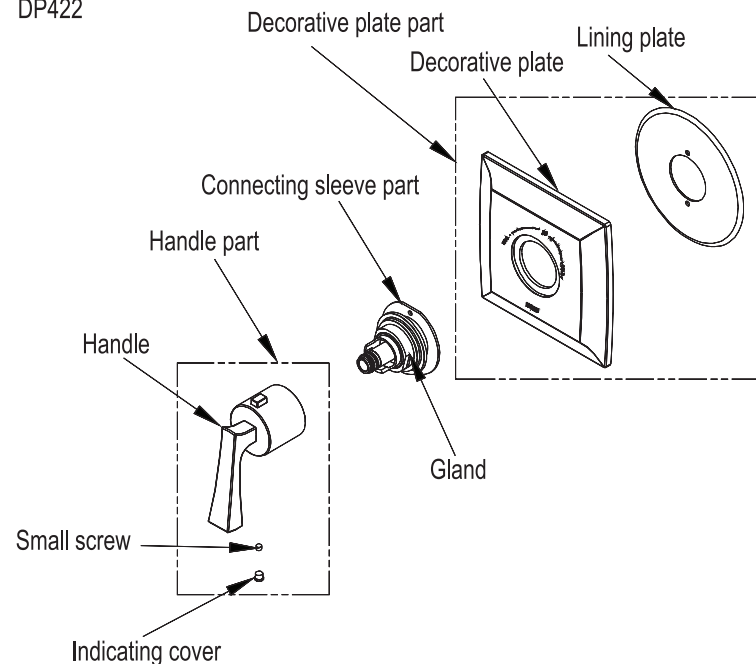

# Water Nozzle Installation

After DV418 properly installed, remove the preservation sleeve. Then put the lining plate DP422 on DV418 and place it on the wall surface upside down. Use the screws fastening the preservation sleeve to fix the connecting sleeve part (※the direction of the connecting sleeve part cut faces up) onto the lining plate. Place the decorative plate onto the connecting sleeve part upside down. Then use the gland to fasten with force. Finally, use small screws to fix the handle. Install the indicating cover.

Note:

A. The positions of different parts (the safety button on the handle part) should be flush with the "38" mark on the decorative plate).

Screw tight the small screws.

B. The water outlet temperature of the water tap is at "38°C" on ex-factory. Customers are requested not to turn the spline receiving hand of DV418 in installation.

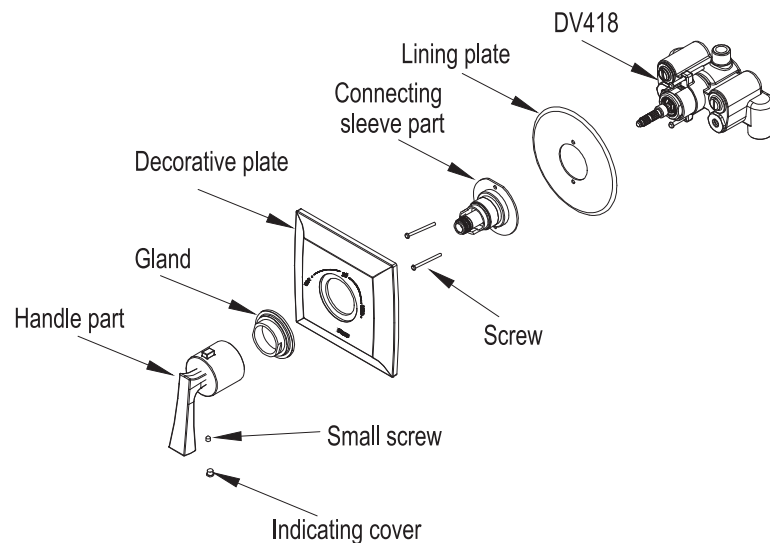

# Water Nozzle Installation

The water tap was adjusted in the factory. However, due to such reasons as pressure condition, etc. on the installation site, sometimes it is unable to achieve the water outlet temperature at the scale. Therefore, adjust by following the main points below. Before adjustment, please confirm the following matters.  
If the water stop valve is fully opened. If the filter net is clogged by dust. If the hot water reaches an enough temperature (10°C higher than the service temperature).

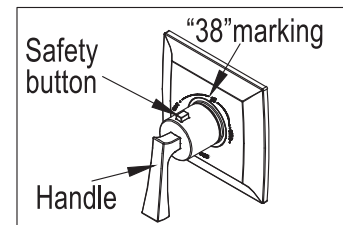

**Main adjustment points**  
Allow the water outlet to jet water. Rotate the handle until the outgoing water temperature reaches 38°C. (When rotating to the high-temperature side, please press the safety button).

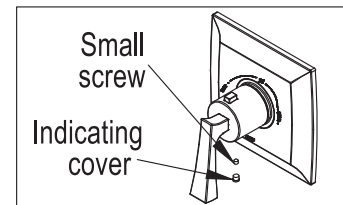

Remove the indicating cover. Please use the prepared hex bar wrench to remove the small screws. Do not use the handle to rotate.

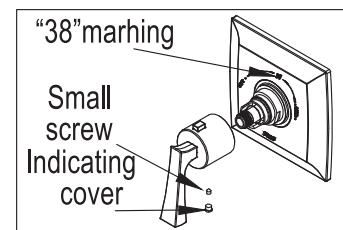

Align the safety button on the handle with the "38" marking on the decorative plate. Install the handle. Screw tight the small screws and put the indicating cover on.

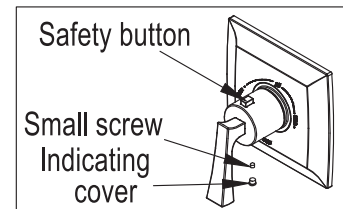

After fixing, confirm again if the outgoing water temperature is 38°C.

# Manufacturer and vendor

---

Applicable standard:QB/T 2806-2017

Product Model No.:See the label on the packaging case

Product name:See the label on the packaging case

Production date:See the label on the packaging case

Assembly factory:TOTO(Dalian)Co.,Ltd.

Telephone:(0411)87624383

Factory address:17 Dong Bei Second Street,Economic&Technical Development zone,Dalian

TOTO(China)Co.,Ltd.

After-sale service toll free telephone all over the country:

800-820-9787(fixed telephone)

400-820-9787(for mobile phone users)

Vendor:TOTO(China)Co.,Ltd.

Address:Room 1915,North Building of Beijing Jiali Center,No.1,  
Guanghua Road,Chaoyang District,Beijing

Website:www.toto.com.cn